

*Bodenbearbeitung praxisnah*



CATALOGUE

2021

2021



# PremiumLtd®

We are a young, dynamically developing company in the field of cultivation machinery. Our offer includes various models of compact disc harrows, as well as cultivators and many other agricultural machines. Our goal is to optimise machines and handle our customers' challenges. High-quality manufacturing is very key to us, we cooperate with suppliers such as Lehner Maschinenbau GmbH or AMA S.p.A.

In this catalogue you will find our products and their retail prices. It is very important to us that our customers receive fast and correct support from our dealers. With this end in view, we are only looking for proficient dealers.



Your  
Premium Ltd team

## CONTACT

Premium Ltd Sp. Z O.O.  
ul. Sienkiewicza 31  
99-100 Łęczyca

Waldemar Obielak  
+48 732 401 503  
office@premiumltd.eu  
www.premiumltd.eu

# CONTENTS

1.	<b>HERMES</b> - Compact Harrow	4
2.	<b>HERMES VARIO</b> - Specialised Compact Harrow	6
3.	<b>HERMES VARIO+H</b> - Specialised Compact Harrow	8
4.	<b>KRONOS</b> - Compact Harrow	10
5.	<b>CERES</b> - Compact Harrow with hitch	12
6.	<b>GIANT</b> - Compact Harrow, Hydraulic Folding	14
7.	<b>GIANT</b> - Compact Harrow, Hydraulic Folding with a Traction Device	16
8.	<b>GIANT PLUS</b> - Compact Harrow, for Liquid Manure Application, Hydraulic Folding	18
9.	<b>ORION K</b> - Combination Ripper	20
10.	<b>ORION K</b> - Combination Ripper, Hydraulic Folding	21
11.	<b>ORION S</b> - Combination Ripper	22
12.	<b>ORION S</b> - Combination Ripper, Hydraulic Folding	23
13.	<b>BELLONA</b> - Grubber Cultivator	24
14.	<b>BELLONA</b> - Grubber Cultivator, Hydraulic Folding (down to 3 m)	26
15.	<b>BELLONA</b> - Grubber Cultivator, Hydraulic Folding	28
16.	<b>BELLONA</b> - Grubber Cultivator, Hydraulic Folding, Central-Wheeled	30
17.	<b>VOLCANO</b> - Grubber Cultivator	32
18.	<b>VOLCANO</b> - Grubber Cultivator, Hydraulic Folding	34
19.	<b>TELLUS</b> - Subsoiler	36
20.	<b>PAN PREMIUM</b> - Multi-purpose Subsoiler	38
21.	<b>PAN FH 250</b> - Subsoiler	40
22.	<b>PAN V</b> - Subsoiler	42
23.	<b>BELLONA</b> - Chisel Shank Conditioner	44
24.	<b>NEPTUN</b> - Mobile Pressure Washer	45
25.	<b>TERRA TANDEM</b> - Cutting shaft	46
26.	<b>TERRA TANDEM PLUS</b> - Cutting shaft	47
27.	<b>TERRA TANDEM</b> - Hydraulic Cutting shaft	48
28.	<b>HOREN</b> - Stubble cultivator	50
29.	Rollers	52
30.	Tandem rollers	54





## Standard equipment:

1. Two rows of discs on rubber shock absorption
2. Discs Ø 510/4 mm and outer discs Ø 460/4 mm on a double bracket
3. Screw-on hubs, maintenance-free
4. Side shields
5. Manual adjustment of working depth
6. Tubular roller Ø 500 mm or flat bar roller Ø 420 mm
7. Hitch of the 1st and 2nd category
8. Frame powder coated

Shield side

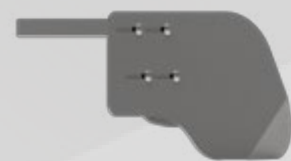

Disc Ø 510 mm lenticular

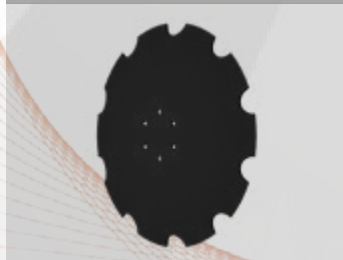

Screw-on hub



Double bracket



Brackets with rubber shock absorption



Manual depth adjustment



Model	Working width (m)	Number of discs	Weight (kg)	Power demand (hp)
1. Hermes 130	1,3	10	≈ 550	35-45
2. Hermes 160	1,6	12	≈ 600	40-50
3. Hermes 180	1,8	14	≈ 650	50-60
4. Hermes 200	2,0	16	≈ 700	60-70
5. Hermes 220	2,2	18	≈ 850	65-75
6. Hermes 250	2,5	20	≈ 900	70-80
7. Hermes 270	2,7	22	≈ 950	75-90
8. Hermes 300	3,0	24	≈ 1000	90-100



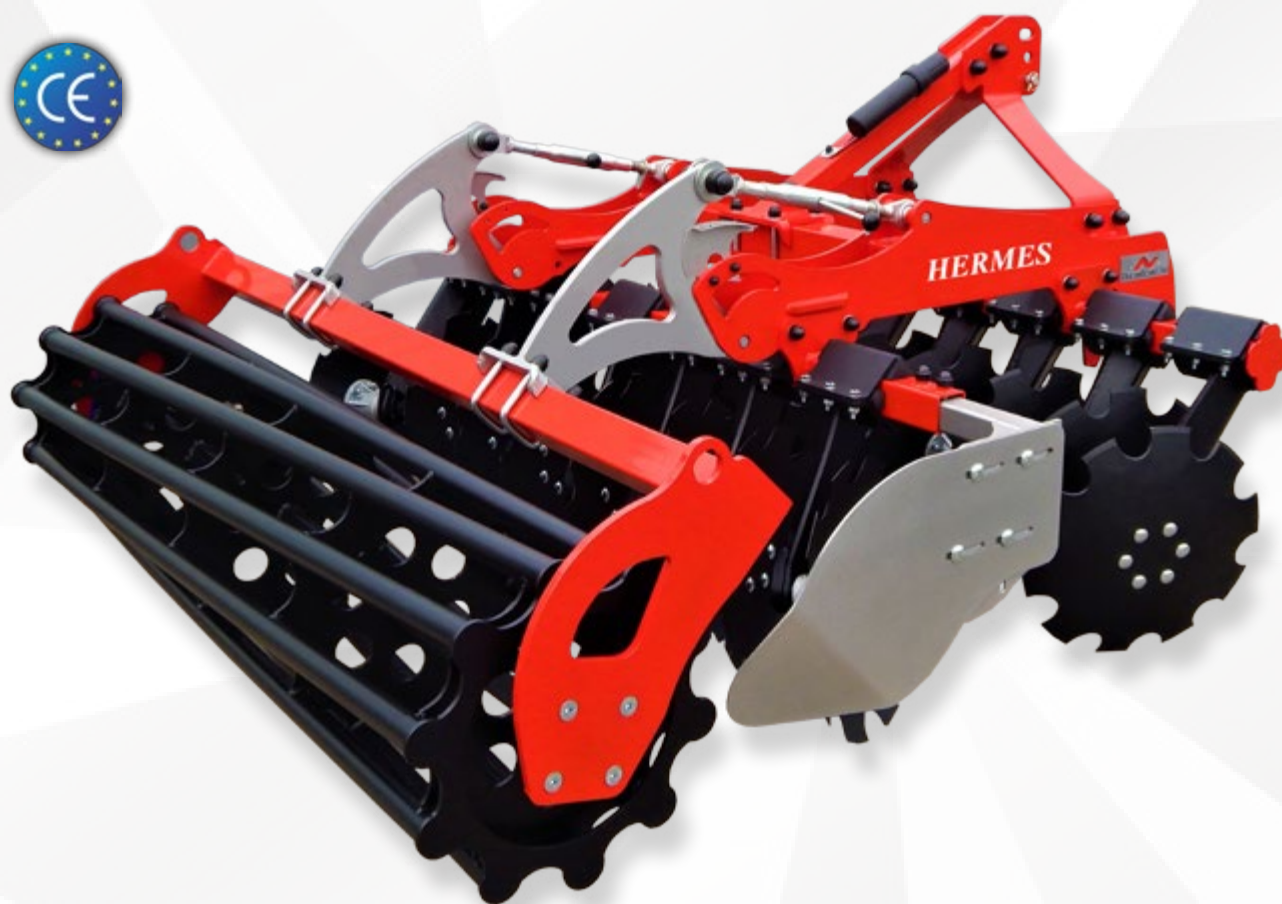

## Optional equipment:

1. Surcharge for V-ring roller Ø 500 mm
2. Surcharge for ring roller Ø 500 mm
3. Hydraulic adjustment of working depth
4. Road traffic lighting
5. Transport costs

Hydraulic adjustment of working depth



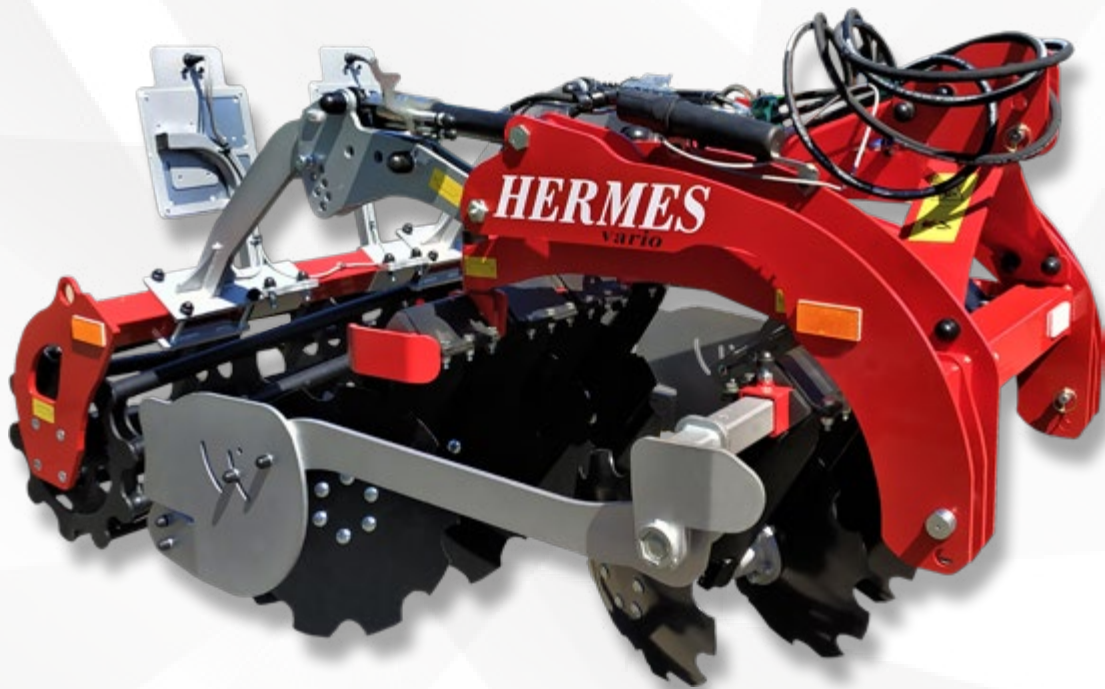

### Standard equipment:

1. Two rows of discs on rubber shock absorption
2. Discs Ø 510/4 mm and outer discs Ø 460/4 mm on a double bracket
3. Screw-on hubs, maintenance-free
4. Side shield floating
5. Hydraulic adjustment of working width
6. Hydraulic adjustment of working depth
7. Hitch of the 1st and 2nd category
8. Tubular roller Ø 500 mm or flat bar roller Ø 420 mm
9. Frame powder coated

Screwed hub



Disc 510 mm lenticular



Side shields floating, adjustable Double bracket

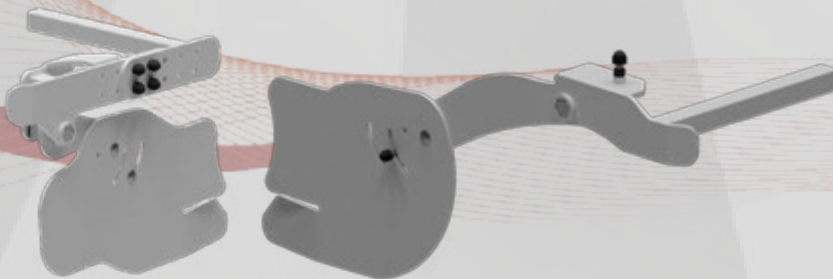

Double bracket



Model	Working width (m)	Number of discs	Weight (kg)	Power demand (hp)
1. Hermes 130-180 Vario	1,3-1,8	10	≈ 500	30/40
2. Hermes 180-220 Vario	1,8-2,2	14	≈ 600	40/60





## Optional equipment:

1. Extension (two brackets with discs)
2. Surcharge for V-ring roller Ø 500 mm
3. Surcharge for ring roller Ø 500 mm
4. Road traffic lighting
5. Other roller
6. Transport costs

Hydraulic adjustment of working width

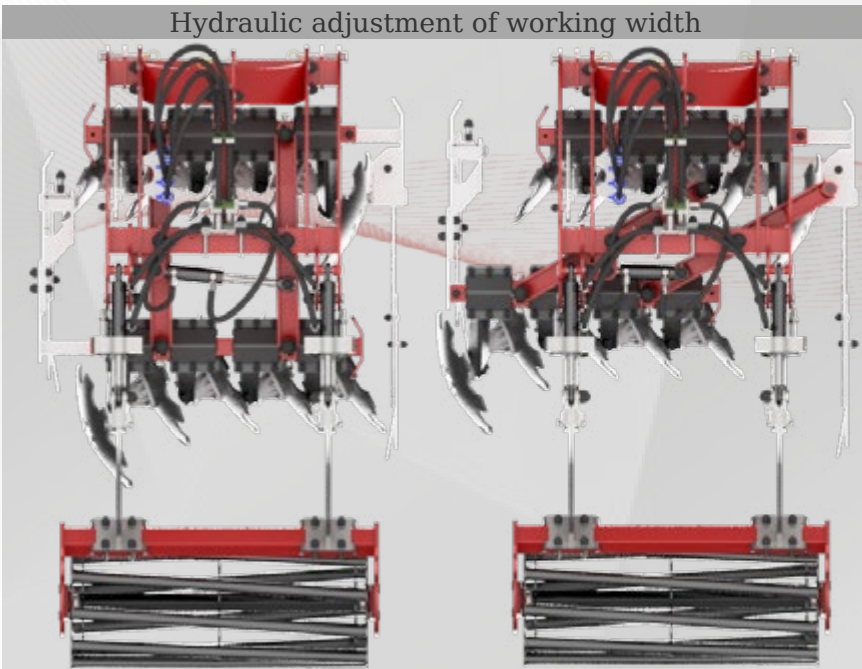

Extension (two brackets with discs)







### Standard equipment:

1. Two rows of discs on rubber shock absorption
2. 2. Discs Ø 510/4 mm and outer discs Ø 460/4 mm on a double bracket
3. Screw-on hubs, maintenance-free
4. Hydraulic adjustment of working depth
5. Tubular roller Ø 500 mm or flat bar roller Ø 420 mm
6. Hydraulic adjustment of working width
7. The roller can be lifted over the machine
8. Hitch of the 1st and 2nd category
9. Side shields floating
10. Frame powder coated

Screw-on hub



Disc Ø 510 mm, lenticular

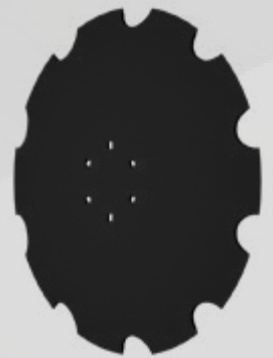

Side shields floating, adjustable

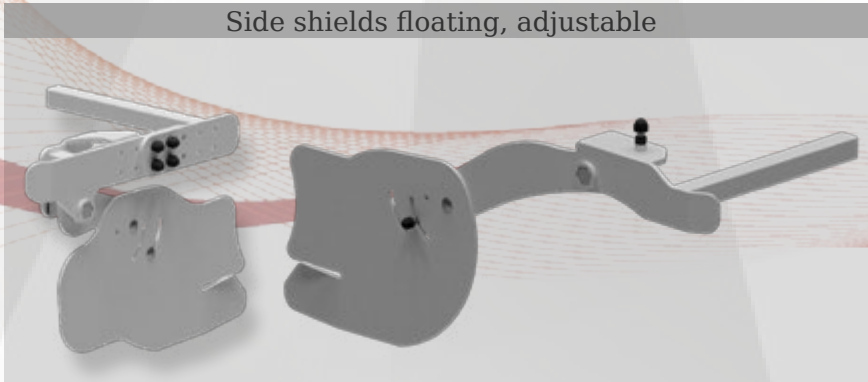

Double bracket



Model	Working width (m)	Number of discs	Weight (kg)	Power demand (hp)
1. Hermes 130-180 Vario + H	1,3-1,8	10	≈ 600	30/40
2. Hermes 180-220 Vario + H	1,8-2,2	14	≈ 700	40/60



## Optional equipment:

1. Extension (two brackets with discs)
2. Surcharge for V-ring roller Ø 500 mm
3. Surcharge for ring roller Ø 500 mm
4. Road traffic lighting
5. Other roller
6. Transport costs

Hydraulic adjustment of working width

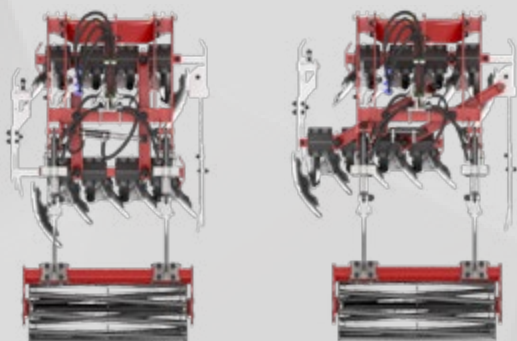

Extension (two brackets with discs)







### Standard equipment:

1. Two rows of discs on rubber shock absorption
2. Discs Ø 560/5 mm
3. Screw-on hubs, maintenance-free
4. Disc beams with the possibility of sliding
5. Side shields
6. Manual adjustment of working depth
7. Hitch of the 2nd and 3rd category
8. Tubular roller Ø 500 mm or flat bar roller Ø 420 mm
9. Frame powder coated

Manual depth adjustment



Side shield

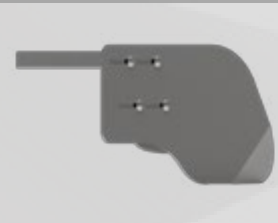

Sliding disc beams



Disc Ø 560 mm flat



Disc Ø 560 mm lenticular

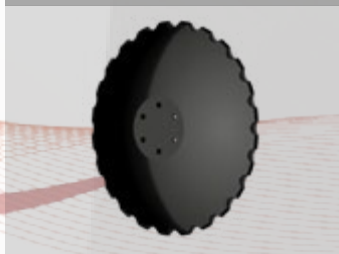

Screw-on hub



Brackets with rubber shock

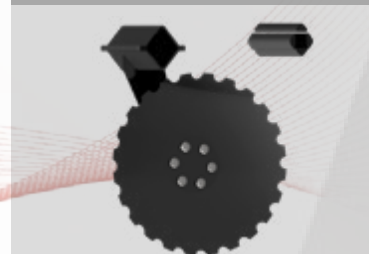

	Model	Working width (m)	Number of discs	Weight (kg)	Power demand (hp)
1.	Kronos 220	2,20	16	≈ 1100	59/80
2.	Kronos 250	2,50	18	≈ 1200	66/90
3.	Kronos 270	2,70	22	≈ 1300	74/100
4.	Kronos 300	3,00	24	≈ 1400	81/110





## Optional equipment:

1. Surcharge for SKF screw-on hub (disc Ø 560 mm)
2. Surcharge for SKF screw-on hub (disc Ø 610 mm)
3. Side shields - set (2 pcs.)
4. XXL shields - set (2 pcs.)
5. Scraper
6. Outrigger for mounting a scraper behind the roller (2 pcs.)
7. Hydraulic adjustment of working depth
8. Surcharge for tubular roller Ø 600 mm
9. Surcharge for V-ring roller Ø 500 mm
10. Surcharge for V-ring roller Ø 600 mm
11. Surcharge for V-ring Plus roller Ø 600 mm
12. Surcharge for ring roller Ø 500 mm
13. Surcharge for mulching roller (pipe Ø 140 mm, tines 180 mm)
14. Surcharge for packer roller Ø 510 mm
15. Surcharge for C-ring roller Ø 520 mm
16. Surcharge for T-ring roller Ø 600 mm
17. Surcharge for disc roller Ø 600 mm
18. Surcharge for crosskill roller Ø 380 mm
19. Surcharge for rubber roller Ø 500 mm
20. Surcharge for tandem roller tubular (Ø 500 mm) & flat bar (Ø 420 mm)
21. Surcharge for flat bar roller Ø 420 mm
22. Surcharge for tandem ring roller Ø 500 mm
23. Surcharge for tandem V-ring roller Ø 500 mm
24. Surcharge for tandem V-ring Plus roller on Ø 500 mm profile
25. Surcharge for tandem C-ring roller Ø 520 mm
26. Surcharge for tandem T-ring roller Ø 600 mm
27. Road traffic lighting
28. Transport costs
29. Pneumatic seeder

Scraper

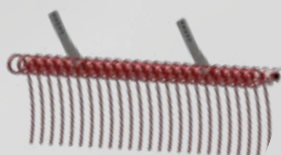

Scraper with outriggers behind

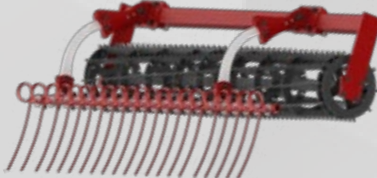

Shields floating



XXL



### Standard equipment:

1. Two rows of discs on rubber shock absorption
2. Discs Ø 560/5 mm
3. Screw-on hubs, maintenance-free
4. Disc beams with the possibility of sliding
5. Side shields
6. Manual adjustment of working depth
7. Lifting device for attaching the seeder (2.5 t)
8. Hitch of the 2nd and 3rd category
9. Tubular roller Ø 500 mm or flat bar roller Ø 420 mm
10. Frame powder coated

Two types of lifting device to choose from (2.5 t)

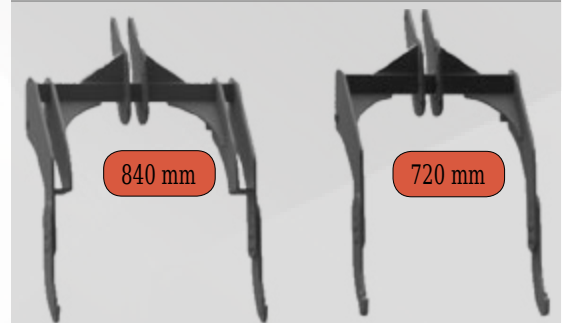

Sliding disc beams



Manual depth adjustment



Disc Ø 560 mm flat



Disc Ø 560 mm, lenticular

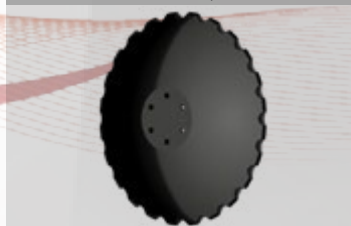

Screw-on hub



Brackets with rubber shock absorption



Side shield

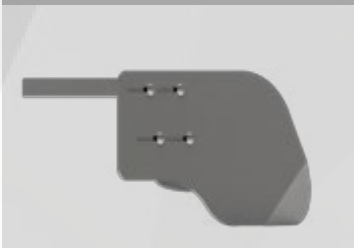

	Model	Working width (m)	Number of discs	Weight (kg)	Power demand (hp)
1.	Ceres 250	2,50	18	≈ 1300	59/80
2.	Ceres 270	2,70	22	≈ 1400	66/90
3.	Ceres 300	3,00	24	≈ 1500	81/110



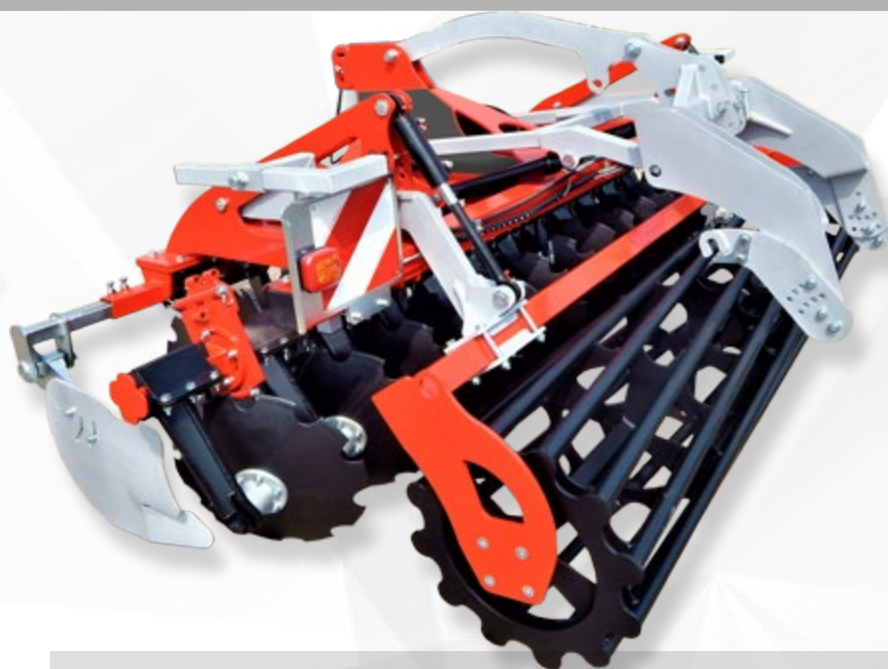

## Optional equipment:

1. Surcharge for SKF screw-on hub (disc Ø 560 mm)
2. Surcharge for SKF screw-on hub (disc Ø 610 mm)
3. Addapitive Side shields - set (2 pcs.)
4. Side shield XXL - (1 pcs.)
5. Hydraulic adjustment of working depth
6. Surcharge for tubular roller Ø 600 mm
7. Surcharge for V-ring roller Ø 500 mm
8. Surcharge for V-ring roller Ø 600 mm
9. Surcharge for V-ring Plus roller Ø 600 mm
10. Surcharge for ring roller Ø 500 mm
11. Surcharge for mulching roller (pipe Ø 140 mm, tines 180 mm)
12. Surcharge for packer roller Ø 510 mm
13. Surcharge for C-ring roller Ø 520 mm
14. Surcharge for T-ring roller Ø 600 mm
15. Surcharge for disc roller Ø 600 mm
16. Surcharge for crosskill roller Ø 380 mm
17. Surcharge for rubber roller Ø 500 mm
18. Surcharge for tandem roller tubular (Ø 500 mm) & flat bar (Ø 420 mm)
19. Surcharge for tandem flat bar roller Ø 420 mm
20. Surcharge for tandem ring roller Ø 500 mm
21. Surcharge for tandem V-ring roller Ø 500 mm
22. Surcharge for tandem V-ring Plus roller on Ø 500 mm profile
23. Surcharge for tandem C-ring roller Ø 520 mm
24. Surcharge for tandem T-ring roller Ø 600 mm
25. Road traffic lighting
26. Transport costs

Shields floating

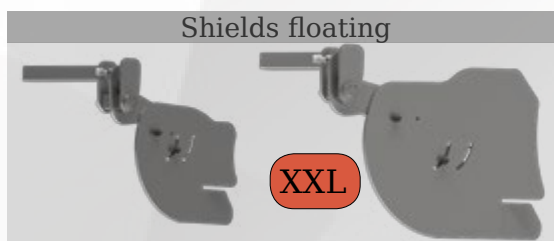





### Standard equipment:

1. Two rows of discs on rubber shock absorption
2. Discs Ø 560/5 mm
3. Hydraulic folding of the machine
4. Screw-on hubs, maintenance-free
5. Disc beams with the possibility of sliding
6. Side shields
7. Manual adjustment of working depth
8. Hitch of the 3rd category
9. Tubular roller Ø 500 mm or flat bar roller Ø 420 mm
10. Frame powder coated

Sliding disc beams

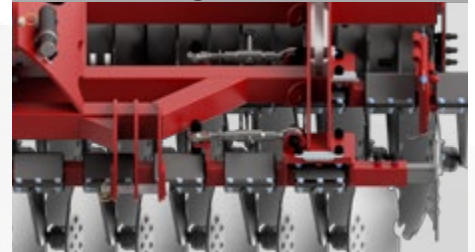

Manual depth adjustment



Disc 560 mm flat



Brackets with rubber shock absorption



Disc 560 mm lenticular



Side shield

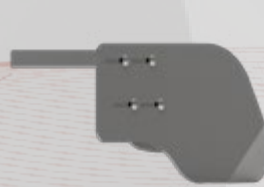

Screw-on hub



	Model	Working width (m)	Number of discs	Weight (kg)	Power demand (hp)
1.	Giant 400	4,00	32	≈ 4200	140/180
2.	Giant 450	4,50	36	≈ 4700	160/200
3.	Giant 500	5,00	40	≈ 5200	180/220
4.	Giant 550	5,50	44	≈ 5700	200/240
5.	Giant 600	6,00	48	≈ 6200	220/260



## Optional equipment:

1. Surcharge for SKF screw-on hub (disc Ø 560mm)
2. Surcharge for SKF screw-on hub (disc Ø 610mm)
3. Side shields - set (2 pcs.)
4. XXL shield - (1 pcs.)
5. Scraper
6. Hydraulic adjustment of working depth
7. Surcharge for tandem V-ring roller Ø 500 mm
8. Surcharge for tandem C-ring roller Ø 520 mm
9. Surcharge for tandem T-ring roller Ø 600 mm
10. Road traffic lighting
11. Transport costs
12. Pneumatic seeder

Side shields floating

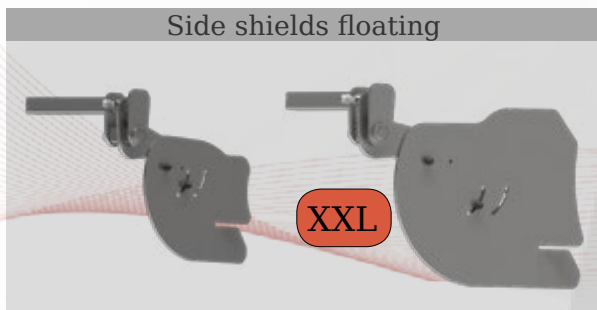

Scraper

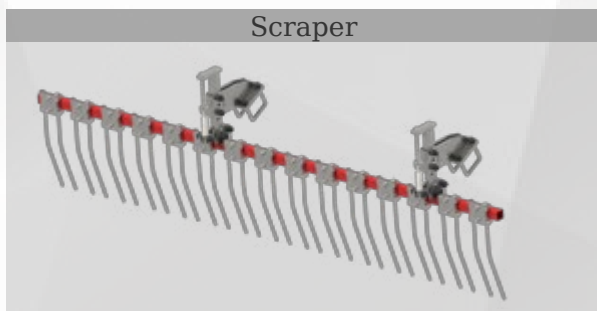

Lehner seeder







### Standard equipment:

1. Two rows of discs on rubber shock absorption
2. Discs Ø 560/5 mm
3. Hydraulic folding of the machine
4. Screw-on hubs, maintenance-free
5. Disc beams with the possibility of sliding
6. Side shields
7. Manual adjustment of working depth
8. Hitch of the 3rd category
9. Traction device (trolley + drawbar)
10. Air brakes
11. Handbremse
12. Tandem V-ring roller Ø 500 mm or tandem ring roller Ø 500 mm
13. Frame powder coated

Sliding disc beams



Manual depth adjustment



Disc 560 mm flat



Brackets with rubber shock absorption



Talerz 560 mm soczewkowy

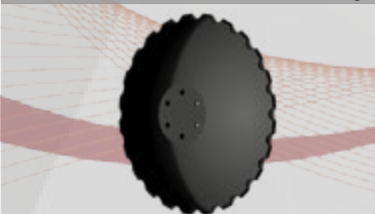

Side shield

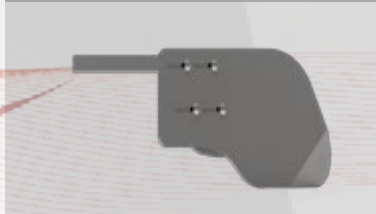

Screw-on hub

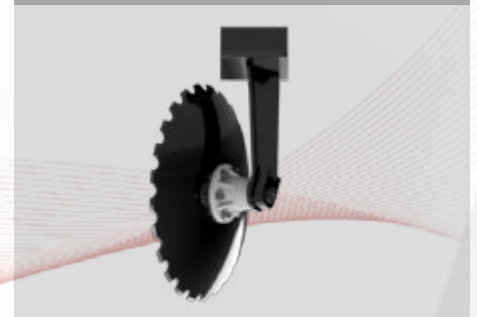

	Model	Working width (m)	Number of discs	Weight (kg)	Power demand (hp)
1.	Giant 400	4,00	32	≈ 5200	140/180
2.	Giant 450	4,50	36	≈ 5700	160/200
3.	Giant 500	5,00	40	≈ 6200	180/220
4.	Giant 550	5,50	44	≈ 6700	200/240
5.	Giant 600	6,00	48	≈ 7200	220/260





## Optional equipment:

1. Surcharge for SKF screw-on hub (disc Ø 560 mm)
2. Surcharge for SKF screw-on hub (disc Ø 610 mm)
3. Side shields - set (2 pcs.)
4. XXL shields - (2 pcs.)
5. Scraper
6. Hydraulic adjustment of working depth
7. Front support wheels
8. Surcharge for tandem V-ring Plus roller on Ø 500 mm profile
9. Surcharge for SKF screw-on hub (disc Ø 560mm)
10. Surcharge for tandem T-ring roller Ø 600 mm
11. Road traffic lighting
12. Transport costs
13. Pneumatic seeder

Side shields floating

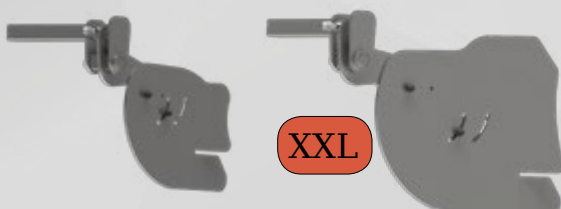

Scraper

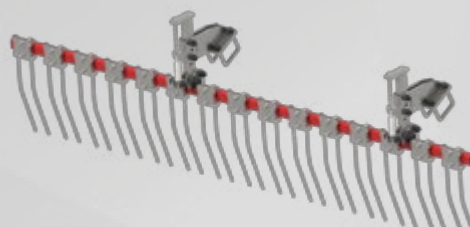

Lehner seeder





### Standard equipment:

1. Two rows of discs on rubber shock absorption
2. Discs Ø 560/5 mm
3. Hydraulic folding of the machine
4. Screw-on hubs, maintenance-free
5. Disc beams with the possibility of sliding
6. Side shields
7. Manual adjustment of working depth
8. Tubular roller Ø 500 mm hot-dip galvanised
9. Hitch of the 3rd category
10. Frame powder-coated
11. Brackets and disc beams are hot-dip galvanised
12. Liquid tenure manifold Vogelsang Dosimat LVX

Disc 560 mm, flat



Rubber shock absorption



Screw-on hub



Sliding disc beams



Disc 560 mm, lenticular



Side shield

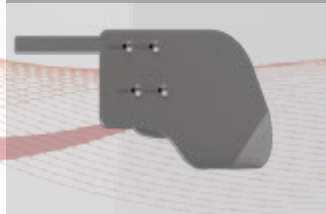

Manual depth adjustment



	Model	Working width (m)	Number of discs	Weight (kg)	Power demand (hp)
1.	Giant plus 400 + Vogelsang Dosimat LVX 16/50	4,00	32	≈ 4200	140/180
2.	Giant plus 500 + Vogelsang Dosimat LVX 20/50	5,00	40	≈ 5200	180/220
3.	Giant plus 600 + Vogelsang Dosimat LVX 24/50	6,00	48	≈ 6200	220/260



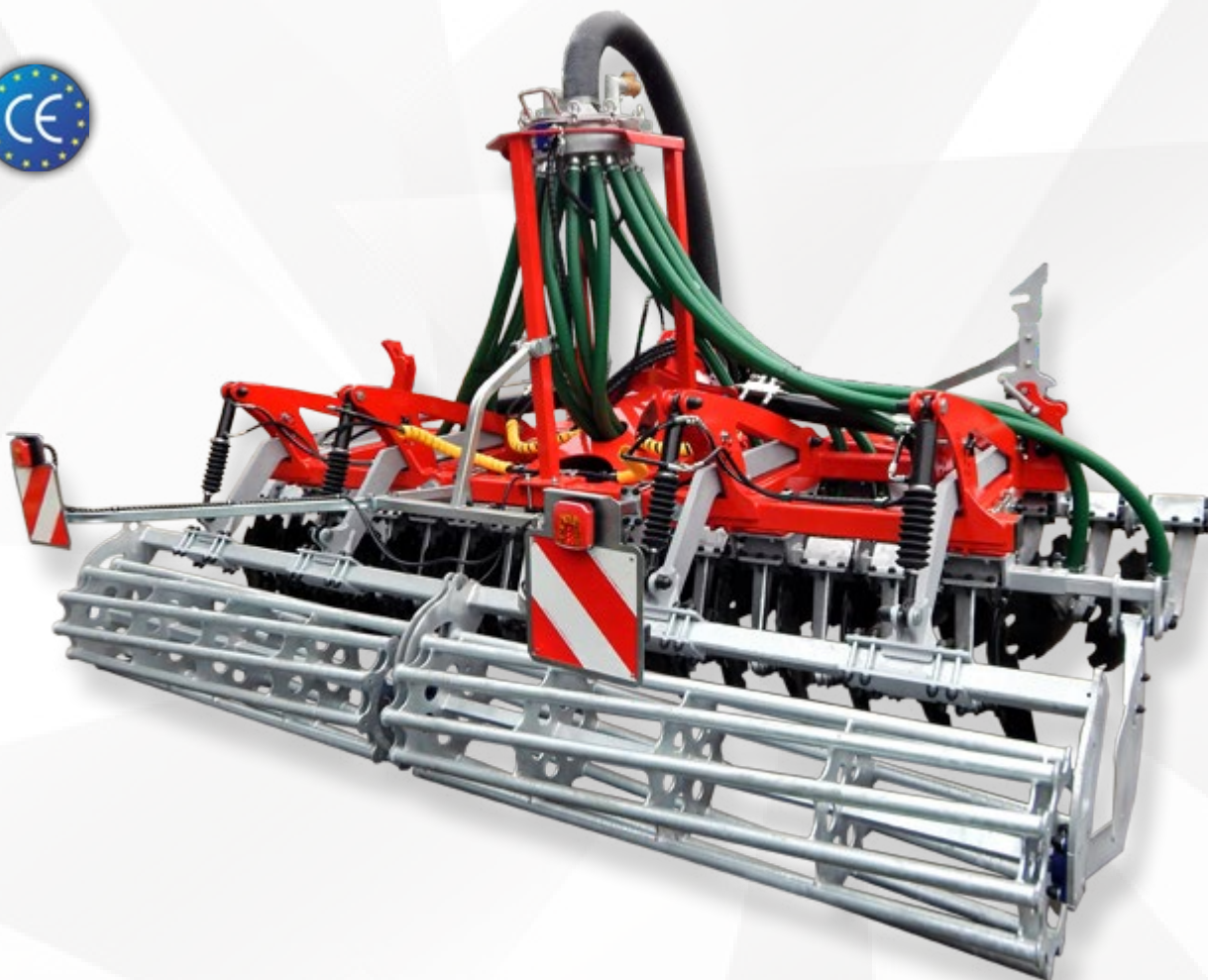

## Optional equipment:

1. Surcharge for SKF screw-on hub (disc Ø 560 mm)
2. Surcharge for SKF screw-on hub (disc Ø 610 mm)
3. Side shields - set (2 pcs.)
4. XXL shields (1 pcs.)
5. Hydraulic adjustment of working depth
6. Road traffic lighting
7. Front support wheels
8. Transport costs

Side shields floating

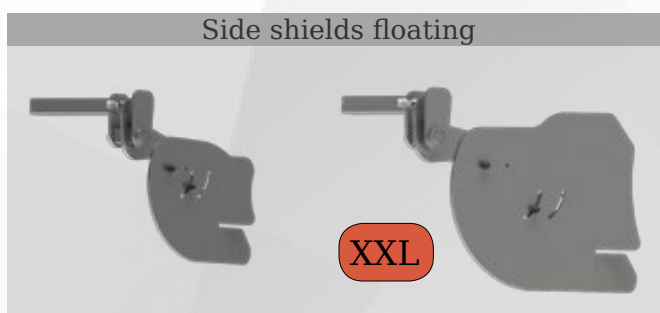



Working elements  
Shear pin protected



### Standard equipment:

1. Two rows of shanks with a working unit
2. Shear pin protected
3. Manual adjustment of working depth
4. Levelling discs Ø 460/4 mm with rubber shock absorption and independent height adjustment
5. Brackets with rubber shock absorption
6. Hitch of 3rd category
7. Tubular roller Ø 500 mm or flat bar roller Ø 420 mm
8. Frame powder coated

	Model	Width (m)	Weight (kg)	Number of shanks	Number of discs	Power demand (hp)
1.	Orion K 180	1.8	≈ 800	4	5	60-70
2.	Orion K 220	2,2	≈ 950	5	6	70-90
3.	Orion K 260	2,6	≈ 1100	6	7	80-100
4.	Orion K 300	3,0	≈ 1200	7	8	90-120

### Optional equipment:

1. Hydraulic adjustment of working depth
2. Surcharge for V-ring roller Ø 500 mm
3. Surcharge for V-ring roller Ø 600 mm
4. Surcharge for V-ring roller Plus Ø 600 mm
5. Surcharge for ring roller Ø 500 mm
6. Surcharge for mulching roller (pipe Ø 140 mm, tines 180 mm)
7. Surcharge for C-ring roller Ø 520 mm
8. Surcharge for T-ring roller Ø 600 mm
9. Surcharge for tandem roller tubular (Ø 500 mm) & flat bar (Ø 420 mm)
10. Surcharge for flat bar roller Ø 420 mm
11. Surcharge for tandem ring roller Ø 500 mm
12. Surcharge for tandem V-ring roller Ø 500 mm
13. Surcharge for tandem V-ring Plus roller on Ø 500 mm profile
14. Surcharge for tandem C-ring roller Ø 520 mm
15. Surcharge for tandem T-ring roller Ø 600 mm
16. Surcharge for 10 mm weld-on side shares (set - right, left)
17. Surcharge for a 10 mm weld-on chisel
18. Road traffic lighting
19. Transport costs
20. Pneumatic seeder





### Standard equipment:

1. Two rows of shanks with a working unit
2. Shear pin protected
3. Hydraulic folding of the machine
4. Manual adjustment of working depth
5. Levelling discs Ø 460/4 mm with rubber shock absorption and independent height adjustment
6. Hitch of 3rd category
7. Tubular roller Ø 500 mm or flat bar roller Ø 420 mm
8. Frame powder coated

	Model	Width (m)	Weight (kg)	Number of shanks	Number of discs	Power demand (hp)
1.	Orion K 400	4,0	≈ 1700	10	11	120-140
2.	Orion K 500	5,0	≈ 2000	12	13	150-170
3.	Orion K 600	6,0	≈ 2300	14	15	170-200

### Optional equipment:

1. Hydraulic adjustment of working depth
2. Surcharge for V-ring roller Ø 500 mm
3. Surcharge for V-ring roller Ø 600 mm
4. Surcharge for V-ring Plus roller Ø 600 mm
5. Surcharge for ring roller Ø 500 mm
6. Surcharge for mulching roller (pipe Ø 140 mm, tines 180 mm)
7. Surcharge for C-ring roller Ø 520 mm
8. Surcharge for T-ring roller Ø 600 mm
9. Surcharge for tandem roller tubular (Ø 500 mm) & flat bar (Ø 420 mm)
10. Surcharge for flat bar roller Ø 420 mm
11. Surcharge for tandem ring roller Ø 500 mm
12. Surcharge for tandem V-ring roller Ø 500 mm
13. Surcharge for tandem V-ring Plus roller Ø 500 mm
14. Surcharge for tandem C-ring roller Ø 520 mm
15. Surcharge for 10 mm weld-on side shares (set - right, left)
16. Surcharge for a 10 mm weld-on chisel
17. Surcharge for tandem T-ring roller Ø 600 mm
18. Road traffic lighting
19. Transport costs
20. Pneumatic seeder

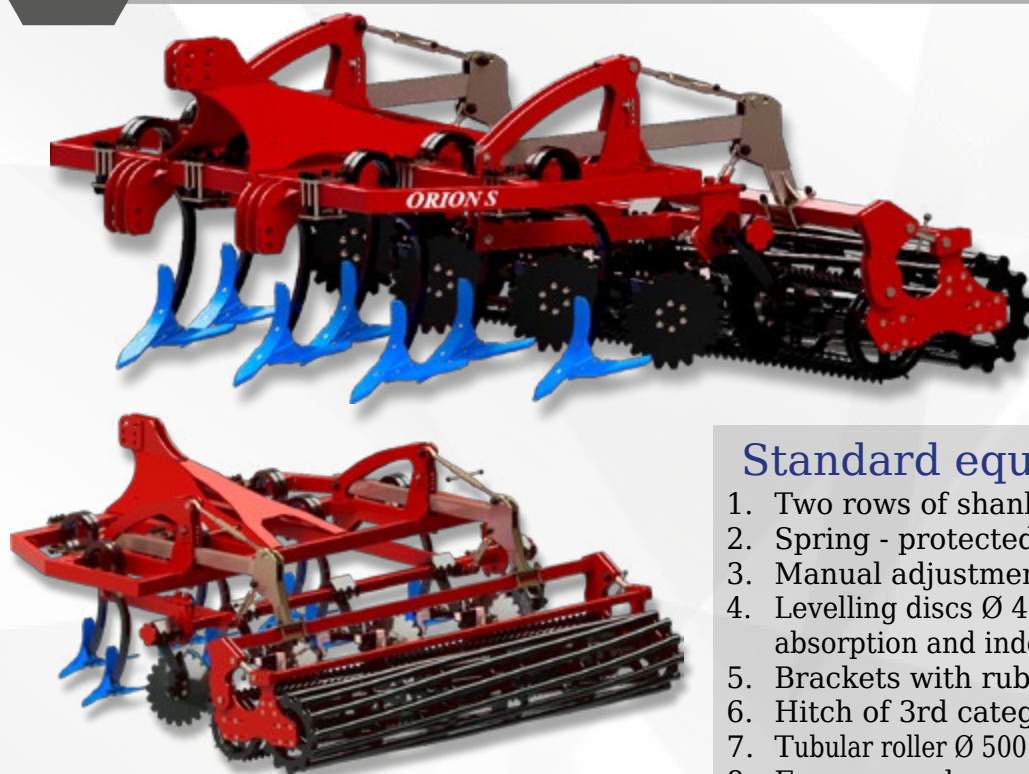

Working elements  
Spring-protected

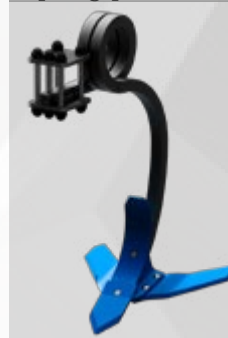

### Standard equipment:

1. Two rows of shanks with a working unit
2. Spring - protected
3. Manual adjustment of working depth
4. Levelling discs Ø 460/4 mm with rubber shock absorption and independent height adjustment
5. Brackets with rubber shock absorption
6. Hitch of 3rd category
7. Tubular roller Ø 500 mm or flat bar roller Ø 420 mm
8. Frame powder coated

	Model	Width (m)	Weight (kg)	Number of shanks	Number of discs	Power demand (hp)
1.	Orion S 180	1,8	≈ 850	4	5	60-70
2.	Orion S 220	2,2	≈ 1000	5	6	70-90
3.	Orion S 260	2,6	≈ 1100	6	7	80-100
4.	Orion S 300	3,0	≈ 1250	7	8	90-120

### Optional equipment:

1. Hydraulic adjustment of working depth
2. Surcharge for V-ring roller Ø 500 mm
3. Surcharge for V-ring roller Ø 600 mm
4. Surcharge for V-ring roller Plus Ø 600 mm
5. Surcharge for ring roller Ø 500 mm
6. Surcharge for mulching roller (pipe Ø 140 mm, tines 180 mm)
7. Surcharge for C-ring roller Ø 520 mm
8. Surcharge for T-ring roller Ø 600 mm
9. Surcharge for tandem roller tubular (Ø 500 mm) & flat bar (Ø 420 mm)
10. Surcharge for flat bar roller Ø 420 mm
11. Surcharge for tandem ring roller Ø 500 mm
12. Surcharge for tandem V-ring roller Ø 500 mm
13. Surcharge for tandem V-ring Plus roller on Ø 500 mm profile
14. Surcharge for tandem C-ring roller Ø 520 mm
15. Surcharge for tandem T-ring roller Ø 600 mm
16. Surcharge for 10 mm weld-on side shares (set - right, left)
17. Surcharge for a 10 mm weld-on chisel
18. Road traffic lighting
19. Transport costs
20. Pneumatic seeder



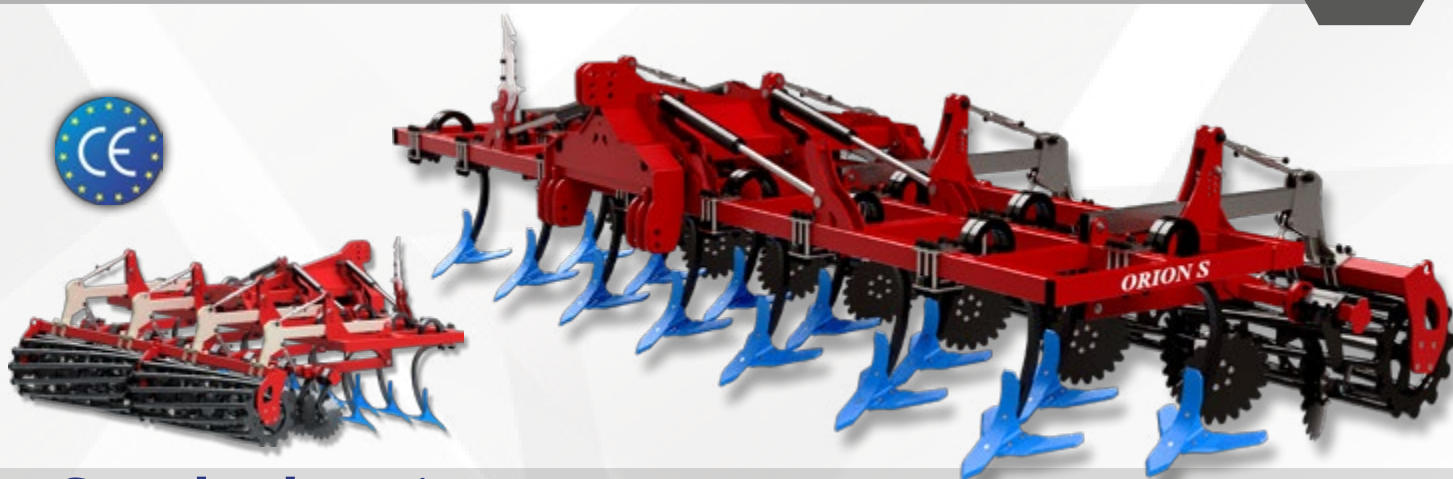

### Standard equipment:

1. Two rows of shanks with a working unit
2. Spring - protected
3. Hydraulic folding of the machine
4. Manual adjustment of working depth
5. Levelling discs Ø 460/4 mm with rubber shock absorption and independent height adjustment

6. Hitch of 3rd category
7. Tubular roller Ø 500 mm or flat bar roller Ø 420 mm
8. Frame powder coated

	Model	Width (m)	Weight (kg)	Number of shanks	Number of discs	Power demand (hp)
1.	Orion S 400	4,0	≈ 1800	10	11	120-140
2.	Orion S 500	5,0	≈ 2100	12	13	150-170
3.	Orion S 600	6,0	≈ 2400	14	15	170-200

### Optional equipment:

1. Hydraulic adjustment of working depth
2. Surcharge for V-ring roller Ø 500 mm
3. Surcharge for V-ring roller Ø 600 mm
4. Surcharge for V-ring Plus roller Ø 600 mm
5. Surcharge for ring roller Ø 500 mm
6. Surcharge for mulching roller (pipe Ø 140 mm, tines 180 mm)
7. Surcharge for C-ring roller Ø 520 mm
8. Surcharge for T-ring roller Ø 600 mm
9. Surcharge for tandem roller tubular (Ø 500 mm) & flat bar (Ø 420 mm)
10. Surcharge for flat bar roller Ø 420 mm
11. Surcharge for tandem ring roller Ø 500 mm
12. Surcharge for tandem V-ring roller Ø 500 mm
13. Surcharge for tandem V-ring Plus roller Ø 500 mm
14. Surcharge for tandem C-ring roller Ø 520 mm
15. Surcharge for 10 mm weld-on side shares (set - right, left)
16. Surcharge for a 10 mm weld-on chisel
17. Surcharge for tandem T-ring roller Ø 600 mm
18. Road traffic lighting
19. Transport costs
20. Pneumatic seeder



### Standard equipment:

1. Three rows of shanks with a working unit
2. Shanks spring-protected
3. Maximum working depth: with side shares up to 15 cm, without shares up to 30 cm
4. Manual adjustment of working depth
5. Levelling discs Ø 460/4 mm with rubber shock absorption and independent height adjustment
6. Brackets with rubber shock absorption
7. Hitch of 3rd category
8. Tubular roller Ø 500 mm or flat bar roller Ø 420 mm
9. Frame powder coated

Working elements spring-protected



	Model	Width (m)	Number of shanks	Number of discs	Weight (kg)	Type of work	Power demand (hp)
1.	Bellona 240	2,40	8	6	≈ 1400	with side shares up to 15 cm without shares 30 cm	120
2.	Bellona 270	2,70	9	7	≈ 1600	with side shares up to 15 cm without shares 30 cm	135
3.	Bellona 300	3,00	10	8	≈ 1800	with side shares up to 15 cm without shares 30 cm	150

Manual adjustment of working depth



Levelling discs with independent adjustment







## Optional equipment:

1. Hydraulic adjustment of working depth
2. Surcharge for tubular roller Ø 600 mm
3. Surcharge for V-ring roller Ø 500 mm
4. Surcharge for V-ring roller Ø 600 mm
5. Surcharge for V-ring Plus roller Ø 600 mm
6. Surcharge for ring roller Ø 500 mm
7. Surcharge for mulching roller (pipe Ø 140 mm, tines 180 mm)
8. Surcharge for C-ring roller Ø 520 mm
9. Surcharge for T-ring roller Ø 600 mm
10. Surcharge for disc roller Ø 600 mm
11. Surcharge for rubber roller Ø 500 mm
12. Surcharge for tandem roller tubular (Ø 500 mm) & flat bar (Ø 420 mm)
13. Surcharge for flat bar roller Ø 420 mm
14. Surcharge for tandem ring roller Ø 500 mm
15. Surcharge for tandem V-ring roller Ø 500 mm
16. Surcharge for tandem V-ring Plus roller on Ø 500 mm profile
17. Surcharge for tandem C-ring roller Ø 520 mm
18. Surcharge for tandem T-ring roller Ø 600 mm
19. Surcharge for weld-on chisels
20. Surcharge for chisels with plate
21. Surcharge for weld-on chisels with plate
22. Surcharge for weld-on side shares - set (right, left)
23. Surcharge for side shares with plate - set (right, left)
24. Road traffic lighting
25. Transport costs
26. Pneumatic seeder



### Standard equipment:

1. Three rows of shanks with a working unit
2. Spring-protected shank
3. Machine hydraulically foldable
4. The design makes work in two widths
5. Maximum working depth: with side shares up to 15 cm, without shares up to 30 cm
6. Manual adjustment of working depth
7. Levelling discs Ø 460/4 mm with rubber shock absorption and independent height adjustment
8. Brackets with rubber shock absorption
9. Tubular roller Ø 500 mm or flat bar roller Ø 420 mm
10. Hitch of 3rd category
11. Frame powder coated

Working elements spring-protected



Manual adjustment of working depth



Levelling discs with independent adjustment



	Model	Width (m)	Number of shanks	Number of discs	Weight (kg)	Type of work	Power demand (hp)
1.	Bellona 420	4,20	14	10	≈ 2900	with side shares up to 15 cm without shares 30 cm	210
2.	Bellona 480	4,80	16	12	≈ 3400	with side shares up to 15 cm without shares 30 cm	240



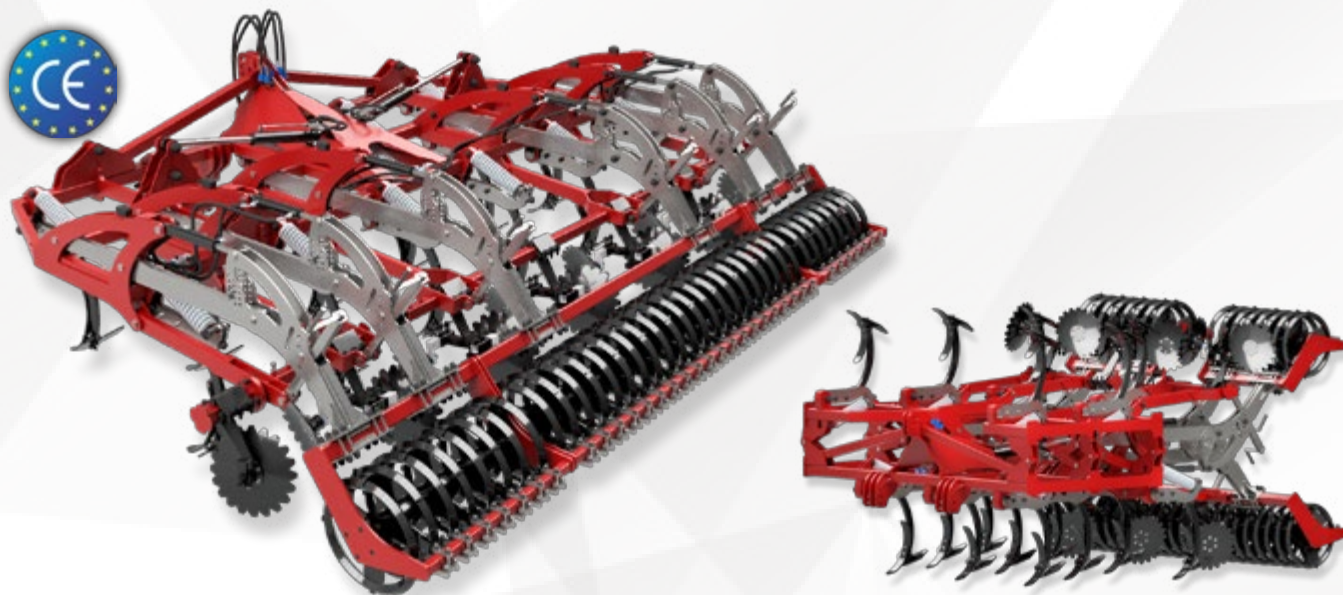

## Optional equipment:

1. Hydraulic adjustment of working depth
2. Surcharge for tubular roller Ø 600 mm
3. Surcharge for V-ring roller Ø 500 mm
4. Surcharge for V-ring roller Ø 600 mm
5. Surcharge for V-ring Plus roller Ø 600 mm
6. Surcharge for ring roller Ø 500 mm
7. Surcharge for mulching roller (pipe Ø 140 mm, tines 180 mm)
8. Surcharge for C-ring roller Ø 520 mm
9. Surcharge for T-ring roller Ø 600 mm
10. Surcharge for disc roller Ø 600 mm
11. Surcharge for rubber roller Ø 500 mm
12. Surcharge for tandem roller tubular (Ø 500 mm) & flat bar (Ø 420 mm)
13. Surcharge for flat bar roller Ø 420 mm
14. Surcharge for tandem ring roller Ø 500 mm
15. Surcharge for tandem V-ring roller Ø 500 mm
16. Surcharge for tandem V-ring Plus roller on Ø 500 mm profile
17. Surcharge for tandem C-ring roller Ø 520 mm
18. Surcharge for tandem T-ring roller Ø 600 mm
19. Surcharge for weld-on chisels
20. Surcharge for chisels with plate
21. Surcharge for weld-on chisels with plate
22. Surcharge for weld-on side shares - set (right, left)
23. Surcharge for side shares with plate - set (right, left)
24. Road traffic lighting
25. Transport costs



### Standard equipment:

1. Three rows of shanks with a working unit
2. Spring-protected shank
3. Hydraulic folding of the machine
4. Maximum working depth: with side shares up to 15 cm, without shares up to 30 cm
5. Feet facilitating
6. Manual adjustment of working depth
7. Levelling discs Ø 460/4 mm with rubber shock absorption and independent height adjustment
8. Brackets with rubber shock absorption
9. Hitch of 3rd category
10. Tubular roller Ø 500 mm or flat bar roller Ø 420 mm
11. Frame powder coated

Spring-protected working element



Manual adjustment of working depth



Levelling discs with independent adjustment



	Model	Width (m)	Number of shanks	Number of discs	Weight (kg)	Type of work	Power demand (hp)
1.	Bellona 360	3,60	12	8	≈ 2400	with side shares up to 15 cm without shares 30 cm	180
2.	Bellona 420	4,20	14	10	≈ 2900	with side shares up to 15 cm without shares 30 cm	210
3.	Bellona 480	4,80	16	12	≈ 3400	with side shares up to 15 cm without shares 30 cm	240





## Optional equipment:

1. Hydraulic adjustment of working depth
2. Surcharge for tubular roller Ø 600 mm
3. Surcharge for V-ring roller Ø 500 mm
4. Surcharge for V-ring roller Ø 600 mm
5. Surcharge for V-ring Plus roller Ø 600 mm
6. Surcharge for ring roller Ø 500 mm
7. Surcharge for mulching roller (pipe Ø 140 mm, tines 180 mm)
8. Surcharge for C-ring roller Ø 520 mm
9. Surcharge for T-ring roller Ø 600 mm
10. Surcharge for disc roller Ø 600 mm
11. Surcharge for rubber roller Ø 500 mm
12. Surcharge for tandem roller tubular (Ø 500 mm)& flat bar(Ø 420 mm)
13. Surcharge for flat bar roller Ø 420 mm
14. Surcharge for tandem ring roller Ø 500 mm
15. Surcharge for tandem V-ring roller Ø 500 mm
16. Surcharge for tandem V-ring Plus roller on Ø 500 mm profile
17. Surcharge for tandem C-ring roller Ø 520 mm
18. Surcharge for tandem T-ring roller Ø 600 mm
19. Surcharge for weld-on chisels
20. Surcharge for chisels with plate
21. Surcharge for weld-on chisels with plate
22. Surcharge for weld-on side shares - set (right, left)
23. Surcharge for side shares with plate - set (right, left)
24. Road traffic lighting
25. Transport costs



### Standard equipment:

1. Three rows of shanks with a working unit
2. Shank spring-protected
3. Hydraulic folding of the machine
4. Maximum working depth: with side shares up to 15 cm, without shares up to 30 cm
5. Hydraulic adjustment of working depth
6. Levelling discs Ø 460/4 mm with rubber shock absorption and independent height adjustment
7. Brackets with rubber shock absorption
8. Hydraulic transport lock
9. Transport wheels inside
10. Front support wheels doubled
11. Hitch of 3rd category
12. Tandem V-ring Plus roller on Ø 500 mm profile or tandem C-ring roller Ø 520 mm or tandem T-ring roller Ø 600 mm
13. Transport costs

Front support wheels doubled



Hydraulic transport lock



	Model	Width (m)	Weight (kg)	Number of shanks	Number of discs	Power demand (hp)
1.	Bellona 420	4,20	≈ 6000	14	12	210-250
2.	Bellona 480	4,80	≈ 6500	16	14	240-280
3.	Bellona 540	5,40	≈ 7000	18	16	270-310

Tandem roller with independent adjustment of levelling discs







## Optional equipment:

1. Surcharge for tandem disc roller Ø 600 mm
2. Hitch eye 40 mm
3. Hitch eye 51 mm
4. K80 ball coupling
5. Surcharge for weld-on chisels
6. Surcharge for chisels with plate
7. Surcharge for weld-on chisels with plate
8. Surcharge for weld-on side shares - set (right, left)
9. Surcharge for side shares with plate - set (right, left)
10. Road traffic lighting
11. Transport costs

### Optional hitches

40 mm



51 mm



K80



### Road traffic lighting





### Standard equipment:

1. Three rows of shanks with chisel, mouldboard and side shares
2. Shanks shear pin protected
3. Maximum working depth: with side shares up to 15 cm without shares up to 30 cm
4. Manual adjustment of working depth
5. Levelling discs Ø 460/4 mm with rubber shock absorption and independent height adjustment
6. Brackets with rubber shock absorption
7. Hitch of 3rd category
8. Tubular roller Ø 500 mm or flat bar roller Ø 420 mm
9. Frame powder coated

Working element protected  
shear pin (standard)



Working element  
spring-protected (optional)

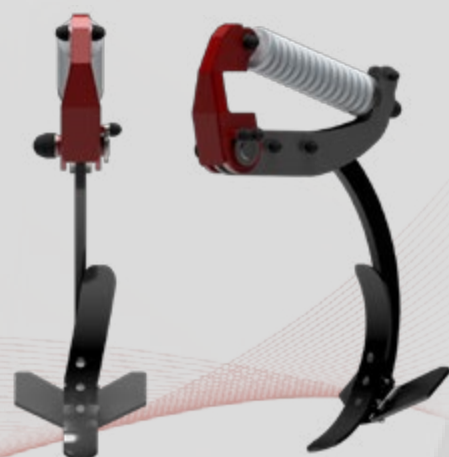

Manual adjustment of working depth



Independent adjustment  
of levelling discs



	Model	Width (m)	Number of shanks	Number of discs	Weight (kg)	Type of work	Power demand (hp)
1.	Volcano 240	2,40	8	6	≈ 1400	with side shares up to 15 cm without side shares 30 cm	120
2.	Volcano 270	2,70	9	7	≈ 1600	with side shares up to 15 cm without side shares 30 cm	135
3.	Volcano 300	3,00	10	8	≈ 1800	with side shares up to 15 cm without side shares 30 cm	150





## Optional equipment:

1. Shanks spring-protected
2. Hydraulic adjustment of working depth
3. Surcharge for tubular roller Ø 600 mm
4. Surcharge for V-ring roller Ø 500 mm
5. Surcharge for V-ring roller Ø 600 mm
6. Surcharge for V-ring Plus roller Ø 600 mm
7. Surcharge for ring roller Ø 500 mm
8. Surcharge for mulching roller (pipe Ø 140 mm, tines 180 mm)
9. Surcharge for C-ring roller Ø 520 mm
10. Surcharge for T-ring roller Ø 600 mm
11. Surcharge for disc roller Ø 600 mm
12. Surcharge for rubber roller Ø 500 mm
13. Surcharge for tandem roller tubular (Ø 500 mm) & flat bar (Ø 420 mm)
14. Surcharge for flat bar roller Ø 420 mm
15. Surcharge for tandem ring roller Ø 500 mm
16. Surcharge for tandem V-ring roller Ø 500 mm
17. Surcharge for tandem V-ring Plus roller on Ø 500 mm profile
18. Surcharge for tandem C-ring roller Ø 520 mm
19. Surcharge for tandem T-ring roller Ø 600 mm
20. Surcharge for 12 mm weld-on chisels
21. Surcharge for 15 mm chisels with plate
22. Surcharge for 15 mm weld-on chisels with plate
23. Surcharge for 20 mm weld-on chisels with plate
24. Surcharge for 40x20 mm weld-on chisels for deep tillage
25. Surcharge for 40x20 mm two-sided weld-on chisels for deep tillage
26. Surcharge for weld-on side shares - set (right, left)
27. Surcharge for side shares with plate - set (right, left)
28. Road traffic lighting
29. Transport costs
30. Pneumatic seeder



### Standard equipment:

1. Three rows of shanks with chisel, mouldboard and side shares
2. Shanks shear pin protected
3. Machine hydraulically foldable - the design makes work in two widths possible
4. Maximum working depth: with side shares up to 15 cm, without shares up to 30 cm
5. Manual adjustment of working depth
6. Levelling discs Ø 460/4 mm with rubber shock absorption and independent height adjustment
7. Brackets with rubber shock absorption
8. Hitch of 3rd category
9. Tubular roller Ø 500 mm or flat bar roller Ø 420 mm
10. Frame powder coated

Working element protected shear pin (standard)



Working element spring-protected (optional)

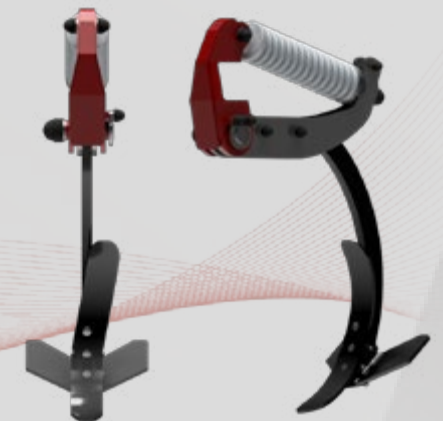

Manual adjustment of working depth

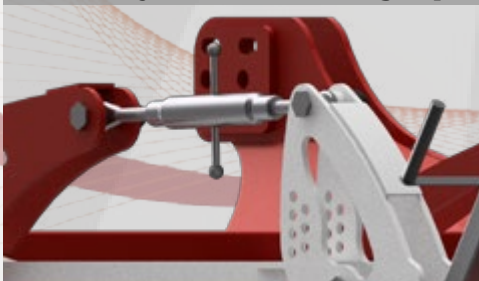

Levelling discs with independent adjustment



	Model	Width (m)	Number of shanks	Number of discs	Weight (kg)	Type of work	Power demand (hp)
1.	Volcano 420	4,20	14	10	≈ 2900	with side shares up to 15 cm without side shares 30 cm	160-190 190-225
2.	Volcano 480	4,80	16	12	≈ 3400	with side shares up to 15 cm without side shares 30 cm	240-280 280-330



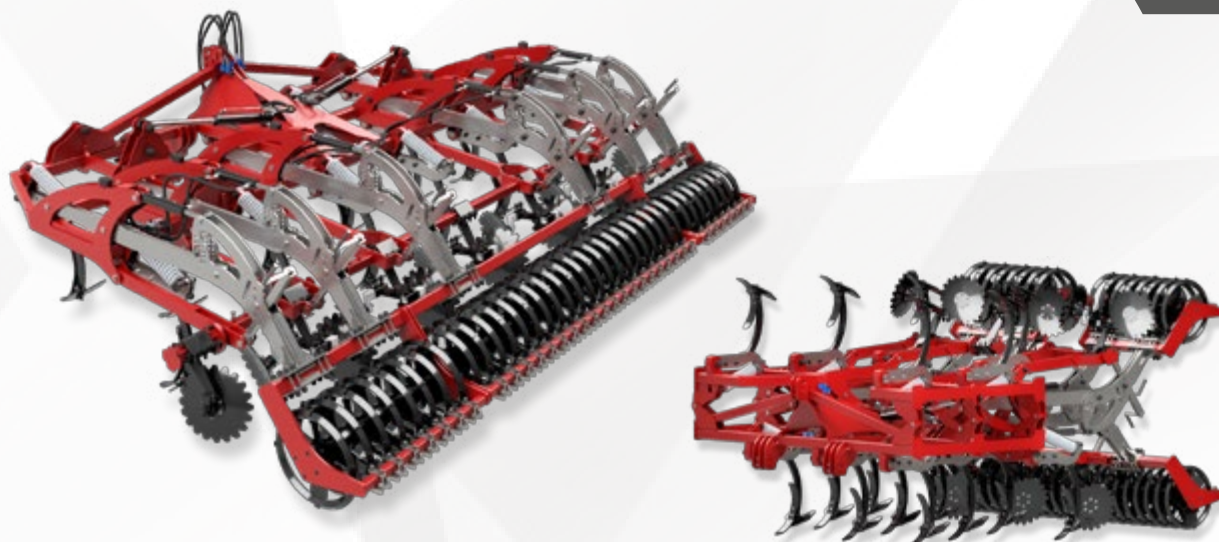

### Optional equipment:

1. Shanks spring-protected
2. Hydraulic adjustment of working depth
2. Surcharge for tubular roller Ø 600 mm
3. Surcharge for V-ring roller Ø 500 mm
4. Surcharge for V-ring roller Ø 600 mm
5. Surcharge for V-ring Plus roller Ø 600 mm
6. Surcharge for ring roller Ø 500 mm
7. Surcharge for mulching roller (pipe Ø 140 mm, tines 180 mm)
8. Surcharge for C-ring roller Ø 520 mm
9. Surcharge for T-ring roller Ø 600 mm
10. Surcharge for disc roller Ø 600 mm
11. Surcharge for rubber roller Ø 500 mm
13. Surcharge for tandem roller tubular (Ø 500 mm) & flat bar (Ø 420 mm)
14. Surcharge for flat bar roller Ø 420 mm
15. Surcharge for tandem ring roller Ø 500 mm
16. Surcharge for tandem V-ring roller Ø 500 mm
17. Surcharge for tandem V-ring Plus roller on Ø 500 mm profile
18. Surcharge for tandem C-ring roller Ø 520 mm
19. Surcharge for tandem T-ring roller Ø 600 mm
20. Surcharge for 12 mm weld-on chisels
21. Surcharge for 15 mm chisels with plate
22. Surcharge for 15 mm weld-on chisels with plate
23. Surcharge for 20 mm weld-on chisels with plate
24. Surcharge for 40x20 mm weld-on chisels for deep tillage
25. Surcharge for 40x20 mm two-sided weld-on chisels for deep tillage
26. Surcharge for weld-on side shares - set (right, left)
27. Surcharge for side shares with plate - set (right, left)
28. Road traffic lighting
29. Transport costs



### Standard equipment:

1. Frame with a transport width of 3 m, enables mounting of four or six working elements on a sliding fixture
2. Working element screwed, with the possibility of sliding
3. The frame is adapted to the installation of two additional extensions with two shanks each, increasing the width to 4 m
4. Working depth up to 50 cm
5. Minimum spacing for four shanks: 520 mm
6. 3rd category hitch
7. Reinforced frame - 180/180/8 mm
8. Frame powder coated

Working element screwed,  
with the possibility of sliding



	Model	Width (m)	Number of shanks	Weight (kg)	Power demand (hp)
1.	Tellus 304	3,0	4	≈ 1165	115
2.	Tellus 306	3,0	6	≈ 1265	170





## Optional equipment:

1. Hydraulic coupling
2. Extension up to 4 m (2 complete working elements)
3. Roller fitting piece
4. Surcharge for tubular roller Ø 500 mm
5. Surcharge for tubular roller Ø 600 mm
6. Surcharge for mulching roller (pipe Ø 140 mm, tines 180 mm)
7. Road traffic lighting
8. Transport costs

Extension



Hydraulic coupling





### Standard equipment:

1. Three-row arrangement of screwed working elements with the possibility of sliding
2. The machine can be attached to the front or rear of the tractor
3. Hitch of the 2nd and 3rd category
4. Frame powder coated

Standard chisel

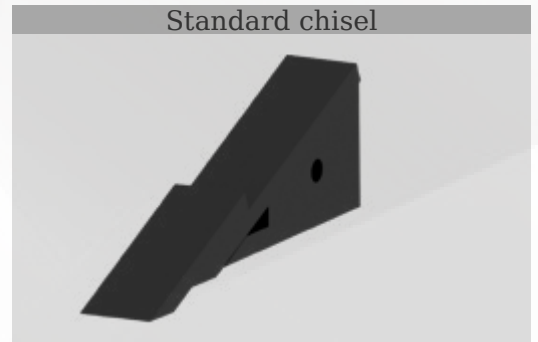

Working element screwed, with the possibility of sliding

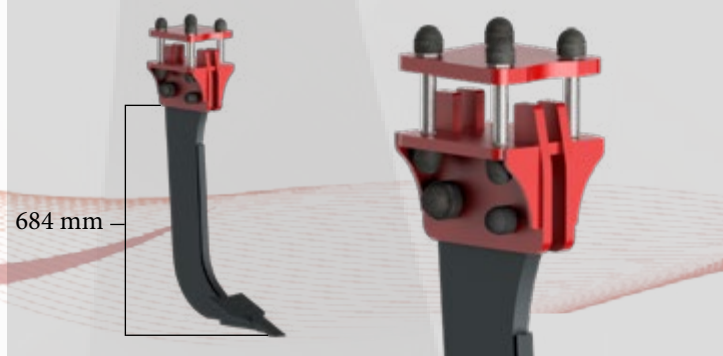

	Model	Width (m)	Number of shanks	Weight (kg)	Power demand (hp)
1.	Pan Premium 3	3,0	3	≈ 1100	90
2.	Pan Premium 4	3,0	4	≈ 1160	120
3.	Pan Premium 5	3,0	5	≈ 1220	150





## Optional equipment:

1. Hydraulic adjustment of the working depth
2. Complete working element with fixtures (60 kg)
3. Surcharge for chisel with side shares (1 pc.)
4. Surcharge for tubular roller  $\varnothing$  500 mm
5. Surcharge for tubular roller  $\varnothing$  600 mm
6. Surcharge for mulching roller (pipe  $\varnothing$  140 mm, tines 180mm)
7. Support wheels (set)
8. Road traffic lighting
9. Freight cost

Chisel with Side Shares

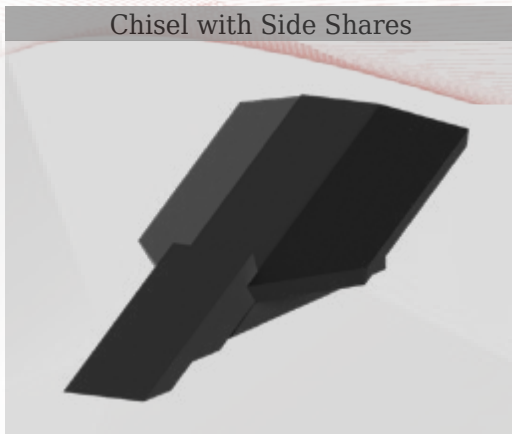

Support wheels





### Standard equipment:

1. Two-row arrangement of screwed working elements with the possibility of sliding
2. The machine can be attached to the front or rear of the tractor
3. Hitch of the 2nd and 3rd category
4. Frame powder coated

Standard chisel



Working element screwed, with the possibility of sliding

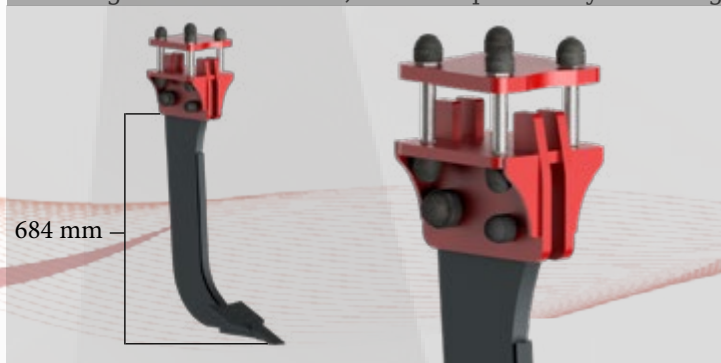

	Model	Width (m)	Number of shanks	Weight (kg)	Power demand (hp)
1.	Pan FH 250	2,5	3	≈ 1100	90





## Optional equipment:

1. Hydraulic adjustment of working depth
2. Surcharge for a chisel with side shares (1 pc.)
3. Surcharge for tubular roller Ø 500 mm
4. Surcharge for tubular roller Ø 600 mm
5. Surcharge for mulching roller (pipe Ø 140 mm, tines 180 mm)
6. Support wheels (set)
7. Road traffic lighting
8. Transport costs

Support wheels



Chisel with side shares





### Standard equipment:

1. Working elements with V-type arrangement
2. Working elements screwed, with the possibility of sliding
3. Hitch of the 2nd and 3rd category
4. Frame powder coated

Standard chisel



Working element screwed, with the possibility of sliding

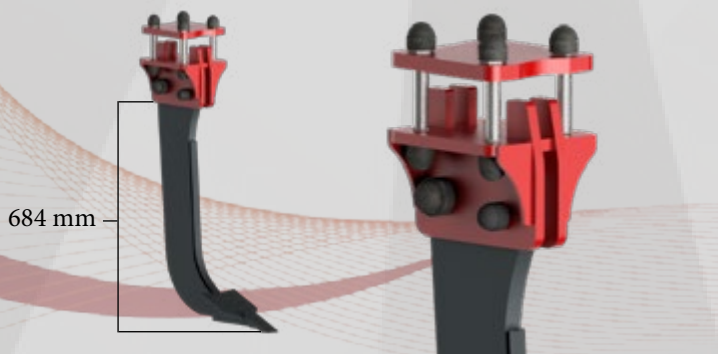

Chisel with Side Shares (optional)

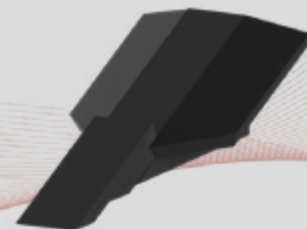

	Model	Width (m)	Number of shanks	Weight (kg)	Power demand (hp)
1.	Pan V	3,0	5	≈ 1300	150



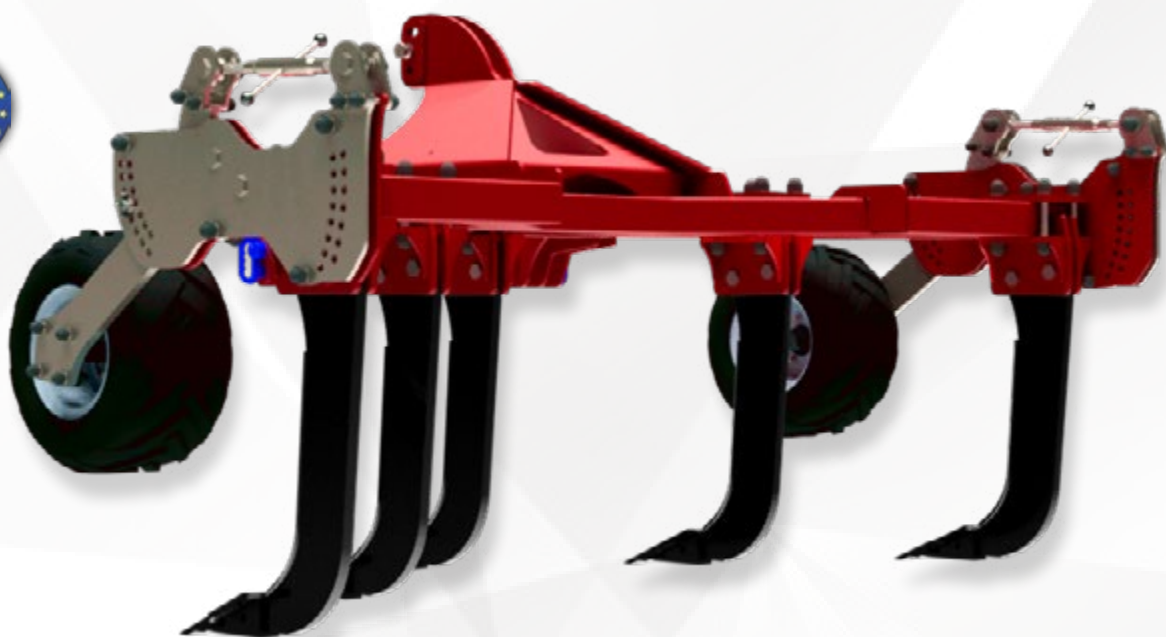

## Optional equipment:

1. Hydraulic adjustment of working depth
2. Surcharge for a chisel with side shares (1 pc.)
3. Surcharge for tubular roller Ø 500 mm
4. Surcharge for tubular roller Ø 600 mm
5. Surcharge for mulching roller (pipe Ø 140 mm, tines 180 mm)
6. Support wheels (set)
7. Road traffic lighting
8. Transport costs

Mulching roller



Adjustable working depth and support wheels

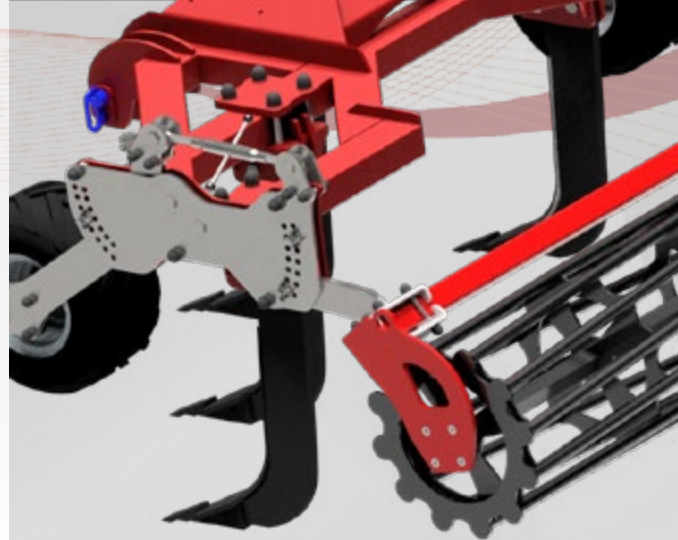

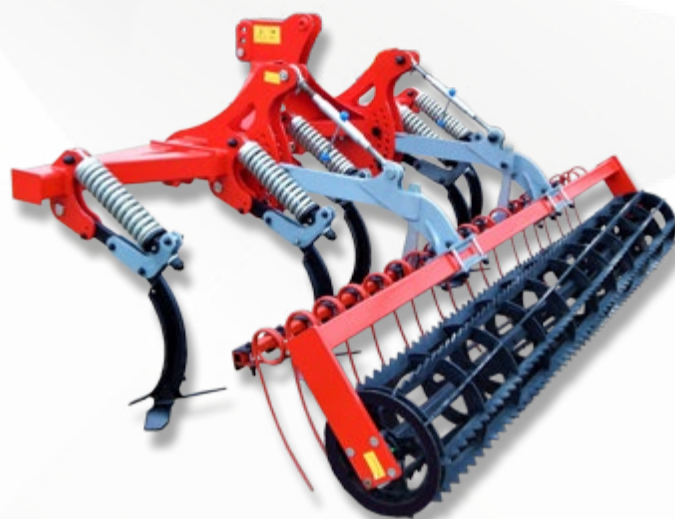

### Standard equipment:

1. Single-row arrangement of working elements
2. Working elements spring-protected
3. Maximum working depth: with side shares up to 15 cm, without shares up to 30 cm
4. Hitch of the 2nd and 3rd category
5. Frame powder coated

	Model	Width (m)	Number of shanks	Weight (kg)	Power demand (hp)
1.	Bellona Chisel Shank Conditioner	3,00	5	≈ 600	65-110

### Optional equipment:

1. Surcharge for tubular roller Ø 500 mm or flat bar roller Ø 420 mm
2. Scraper
3. Hydraulic adjustment of working depth
4. Road traffic lightig
5. Transport costs





### Standard equipment:

1. Main tank capacity 600 l, which allows for 30-40 minutes of continuous operation
2. Washing liquid tank - 20 l
3. Clean water tank for washing hands - 60 l
4. Hydraulic pump with a flow rate of 17-20 l/min, generating water pressure up to 150 bar
5. Maximum pressure in the tractor or forklift system up to 80 l/min
6. Water filter
7. Filling sieve in the main tank
8. Three-point-hitch - 2nd category
9. Lifting apertures for transporting the washer with a forklift
10. Double wash lance with foam function
11. Automatic hose reel made of stainless steel,
12. Hose 20 m
13. Use of salt water allowed
14. Maximum water temperature 60°C.
15. Road traffic lighting

### Optional equipment:

1. Rotating nozzle
2. Nozzle for unclogging drains
3. Rotating nozzle for unclogging drains

	Model	Tankage (l)	Net weight (kg)
1.	Neptun	600	≈ 250



### Standard equipment:

1. Two blade rollers, with a diameter of Ø 350 mm each, mounted on a rubber shock absorbers
2. The first roller with six blades and the second with seven blades
3. Blades with a thickness of 8 mm made of 30MnB5 hardened steel
4. Front and back attachment possible
5. Safety covers
6. Stands
7. Hitch of the 2nd category
8. Bearings covers
9. Frame powder coated

	Model	Width (m)	Weight (kg)	Power demand (KM)
1.	Terra Tandem 200	2,0	≈ 700	60
2.	Terra Tandem 240	2,4	≈ 800	75
3.	Terra Tandem 300	3,0	≈ 900	90

### Optional equipment:

1. Road traffic lighting
2. Weight 27 kg - pcs.
3. Transport costs

The Terra Tandem Plus machine is equipped with two cutting rollers. The first roller, with a diameter of Ø 500 mm, is divided into three segments. Each segment with 10 blades works with independent spring shock absorption. This allows the roller to adapt to the unevennesses of the terrain. The other roller, with a diameter of Ø 350 mm, is equipped with six rows of blades, which are mounted on rubber shock absorbers of Ø 50 mm diameter protecting them against damage. The diagonal arrangement of blades ensures an even distribution of the cutting force, and thus an even work result. The blades are positioned at opposite angles to each other, which allows for obtaining a cross-sectional effect. The optimum speed is over 12 km/h. The roller should not go deeper than 3 cm into the soil. You can make your work more efficient by adding additional weights (27 kg per weight, maximum approx. 300 kg).





### Standard equipment:

1. Two blade rollers with rubber shock absorption
  - the first one with a diameter of Ø 500 mm, on spring shock absorbers
  - the second one with a diameter of Ø 350 mm, with rubber shock absorption
2. Blades with a thickness of 8 mm made of 30MnB5 hardened steel
3. Front and back attachment possible
4. Safety covers
5. Stands
6. Hitch of the 2nd category
7. Bearings covers
8. Frame powder coated

	Model	Width (m)	Weight (kg)	Power demand (KM)
1.	Terra Plus Tandem 200	2,0	≈ 800	60
2.	Terra Plus Tandem 240	2,4	≈ 900	75
3.	Terra Plus Tandem 300	3,0	≈ 1000	90

### Optional equipment:

1. Road traffic lighting
2. Weight 27 kg - pcs.
3. Transport costs

The Terra Tandem Plus machine is equipped with two cutting rollers. The first roller, with a diameter of Ø 500 mm, is divided into three segments. Each segment with 10 blades works with independent spring shock absorption. This allows the roller to adapt to the unevennesses of the terrain. The other roller, with a diameter of Ø 350 mm, is equipped with six rows of blades, which are mounted on rubber shock absorbers of Ø 50 mm diameter protecting them against damage. The diagonal arrangement of blades ensures an even distribution of the cutting force, and thus an even work result. The blades are positioned at opposite angles to each other, which allows for obtaining a cross-sectional effect. The optimum speed is over 12 km/h. The roller should not go deeper than 3 cm into the soil. You can make your work more efficient by adding additional weights (27 kg per weight, maximum approx. 300 kg).



### Standard equipment:

1. Two blade rollers, with a diameter of Ø 350 mm each, mounted on a rubber shock absorbers
2. The first roller with six blades and the second with seven blades
3. Blades with a thickness of 8 mm made of 30MnB5 hardened steel
4. Hydraulically foldable outriggers facilitate transport of the machine on public roads
5. The machine suspension system facilitates work along a curve.
6. Front and back attachment possible
7. Safety covers
8. Stands
9. Hitch of the 2nd category
10. Bearings covers
11. Frame powder coated



	Model	Width (m)	Weight (kg)	Power demand (KM)
1.	Terra Tandem 400	4,0	≈ 1100	120-140
2.	Terra Tandem 500	5,0	≈ 1300	140-160
3.	Terra Tandem 600	6,0	≈ 1500	160-180

### Optional equipment:

	Terra Tandem 400	Terra Tandem 500	Terra Tandem 600
1. Road traffic lighting	600,00	600,00	600,00
2. Weight 27 kg - pcs.	50,00	50,00	50,00
3. Transport costs	Ask about price		





The system facilitates work



Stands

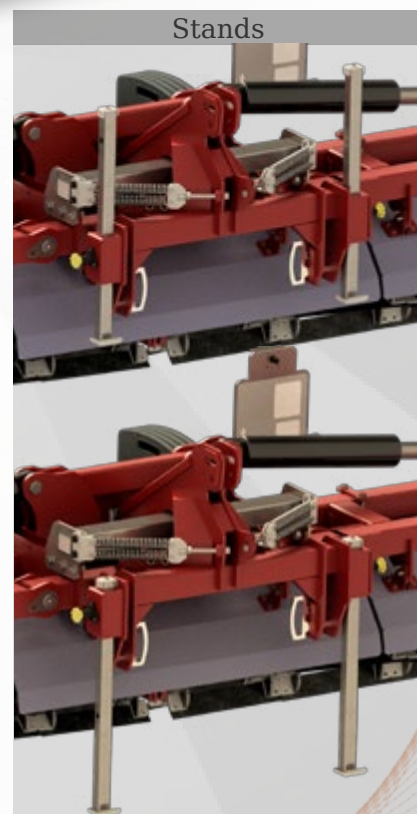

Road traffic lighting



Weights

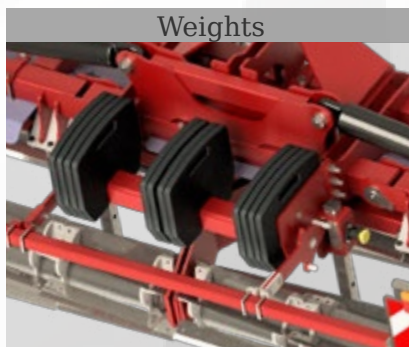

Thanks to the use of hydraulic cylinders, the machine can be folded into transport position and thus transported on public roads. The Terra Tandem machine is equipped with two blade rollers, the first of Ø 350 mm diameter with six blades, and the other of Ø 405 mm diameter with seven blades. The blade rows are arranged diagonally and divided into segments. The rollers are mounted on Ø 50 mm rubber shock absorbers protecting them against damage. The diagonal arrangement of blades ensures an even distribution of the cutting force, and thus an even work result. The blades are positioned at opposite angles to each other, which allows for obtaining a crosssectional effect. The machine suspension system used here facilitates a correction of the driving direction. The optimum speed is over 12 km/h. The roller should not go deeper than 3 cm into the soil. You can improve your work by adding more weights.



### Standard equipment:

1. Four rows of working elements
2. Working elements - tines 70mm x 12mm with goosefoot
3. Hydraulic folding of the machine - 4m and larger
4. Hydraulic transport lock
5. Support feet for parking the machine in a folded position - 4 m and above
6. Manual adjustment of working depth
7. Hitch of the 3rd category
8. Ring roller Ø 420 mm
9. Frame powder coated

70x12mm tooth with goosefoot



Manual adjustment of working depth



Hydraulic transport lock



Goosefoot  
180/5

straight and rotary  
working ele-  
ment 53/8/303



	Model	Width (m)	Working elements amount	Weight (kg)	Power demand (KM)
1.	Horen 300	3,0	21	≈ 1200	110-130
2.	Horen 400	4,0	27	≈ 2000	130-150
3.	Horen 500	5,0	35	≈ 2300	150-170
4.	Horen 600	6,0	41	≈ 2600	170-190





## Optional equipment:

1. Scraper
2. Surcharge for ring roller Ø 500 mm
3. Surcharge for V-ring roller Ø 500 mm
4. Surcharge for tandem tubular roller Ø 500 mm
5. Surcharge for tandem roller tubular (Ø 500 mm) & flat bar Ø 420 mm)
6. Surcharge for flat bar roller Ø 420 mm
7. Surcharge for tandem ring roller Ø 500 mm
8. Road traffic lighting
9. Transport costs
10. Pneumatic seeder

Scraper

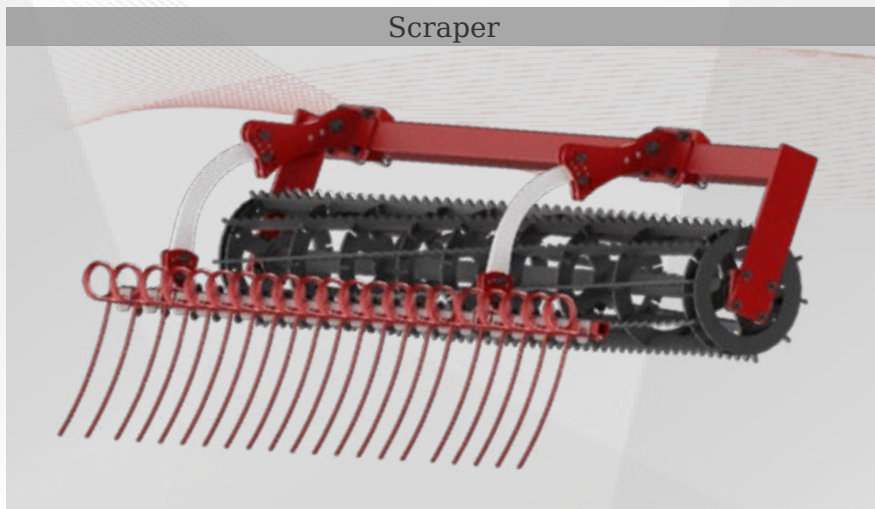

Stands

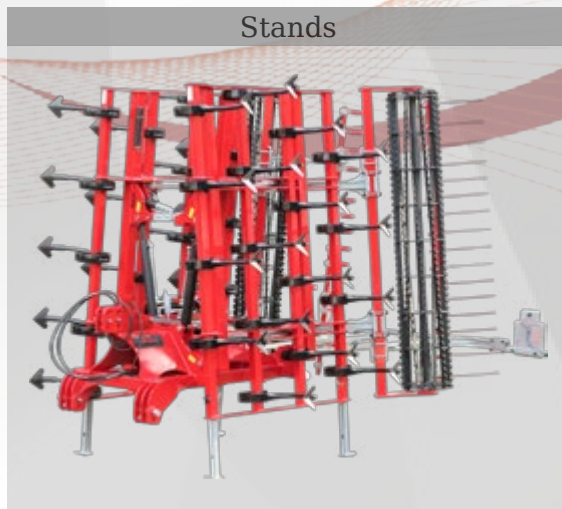

## Tubular roller

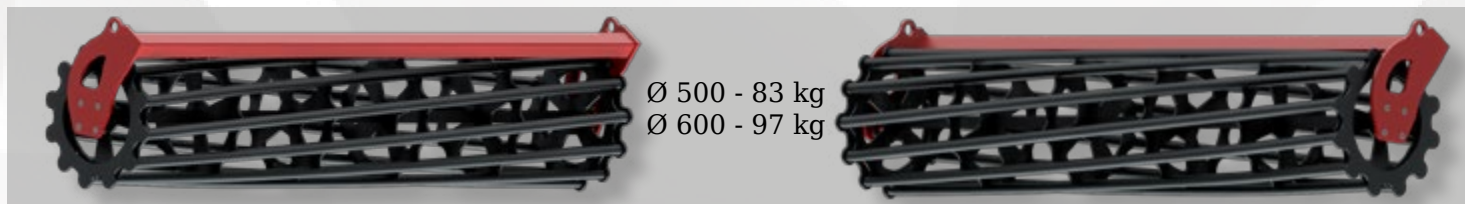

## Ring roller



## Helical roller



## Ring roller



## V-ring roller

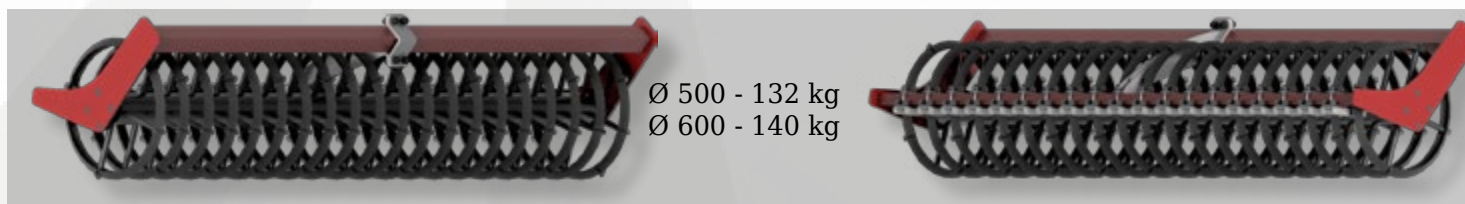

## V-ring Plus roller

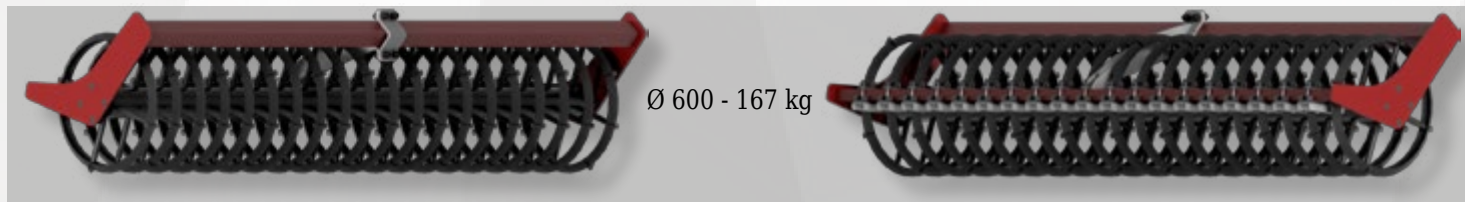

## Disc roller





## Crosskill roller



## Rubber roller



## Packer roller



## T-ring roller



## C-ring roller



1. Tubular roller Ø 500 mm
2. Tubular roller Ø 600 mm
3. Flat bar roller Ø 420 mm
4. Helical roller Ø 500 mm
5. Ring roller Ø 500 mm
6. V-ring roller Ø 500 mm
7. V-ring roller Ø 600 mm
8. V-ring Plus roller Ø 600 mm (on a profile)
9. Disc roller Ø 600 mm
10. Crosskill roller Ø 380 mm
11. Rubber roller Ø 500 mm
12. Packer roller Ø 510 mm
13. T-ring roller 600 mm
14. C-ring roller Ø 520 mm

## Tandem roller flat bar & tubular

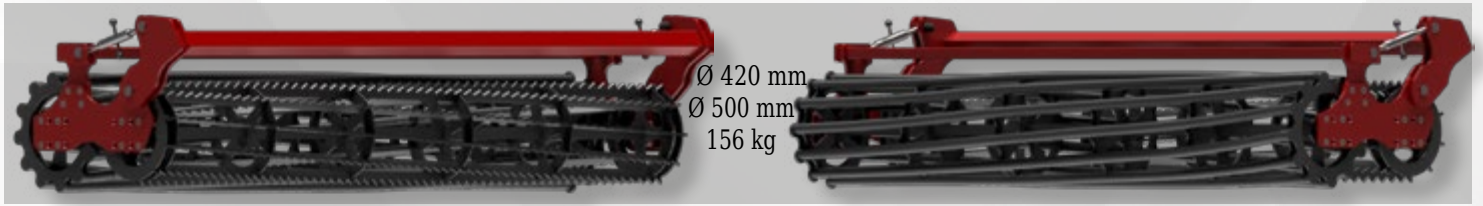

## Tandem flat bar roller



## Mulching roller

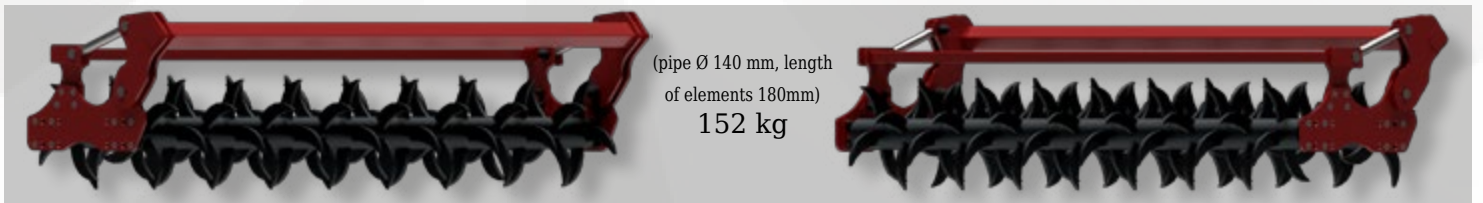

## Tandem ring roller

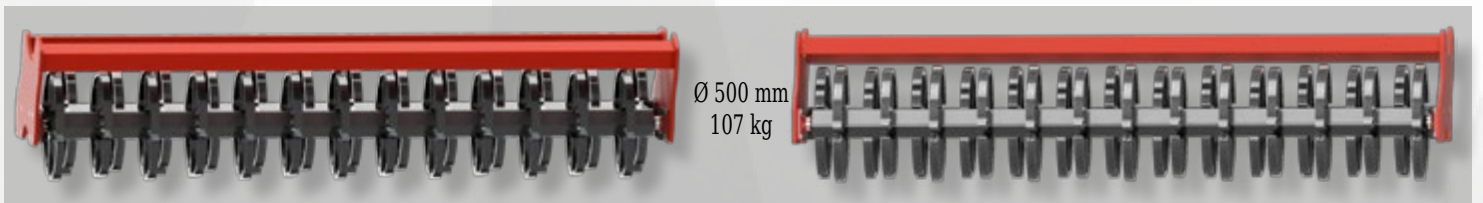

## Tandem V-ring roller





## Tandem V-ring Plus roller

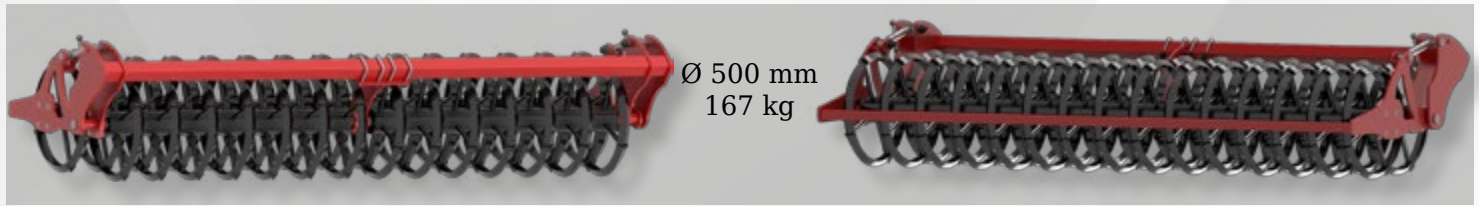

## Tandem C-ring roller

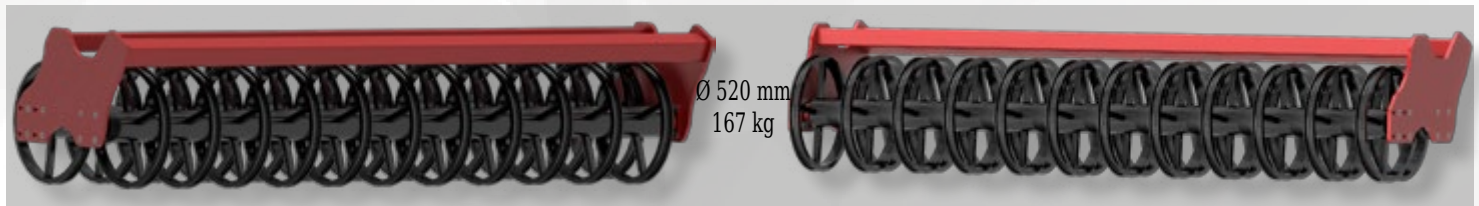

## Tandem T-ring roller



1. Tandem roller flat bar (Ø 420 mm) & tubular (Ø 500 mm)
2. Tandem flat bar roller Ø 420 mm
3. Mulching roller (tube Ø 140 mm, tines 180 mm)
4. Tandem ring roller Ø 500 mm
5. Tandem V-ring roller Ø 500 mm
6. Tandem V-ring Plus roller Ø 500 mm (on a profile)
7. Tandem C-ring roller Ø 520 mm
8. Tandem T-ring roller Ø 600 mm



*Bodenbearbeitung praxisnah*

CATALOGUE

2021

2021